

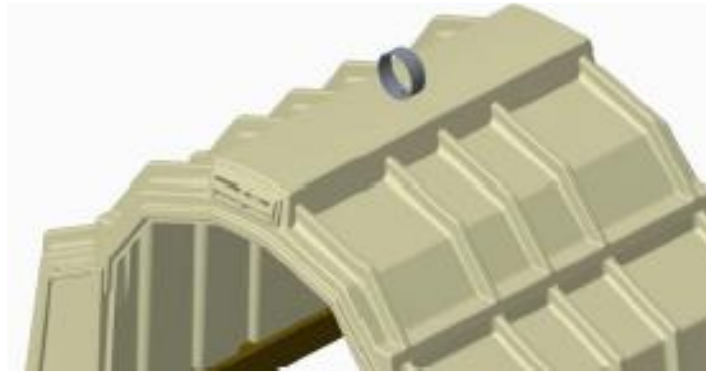

## 54|98 Lifting Device Assembly Instructions



### Calf-Tel 54|98 Lifting Device Bill of Material:

Item	Item Number	Description	Qty
1	CT-6192	Lifting Bracket and Lifting Ring	1
2	CT-HDWE-004	(2) 1/2-13 x 1-1/2 Bolts, (5) 1.0 Washers, and (3) 1/2 -13 Nuts	1

### Tools Needed:

1. 9/16" Drill Bit
2. Drill
3. 1/2" Deep Well Socket
4. 1/2" Wrench

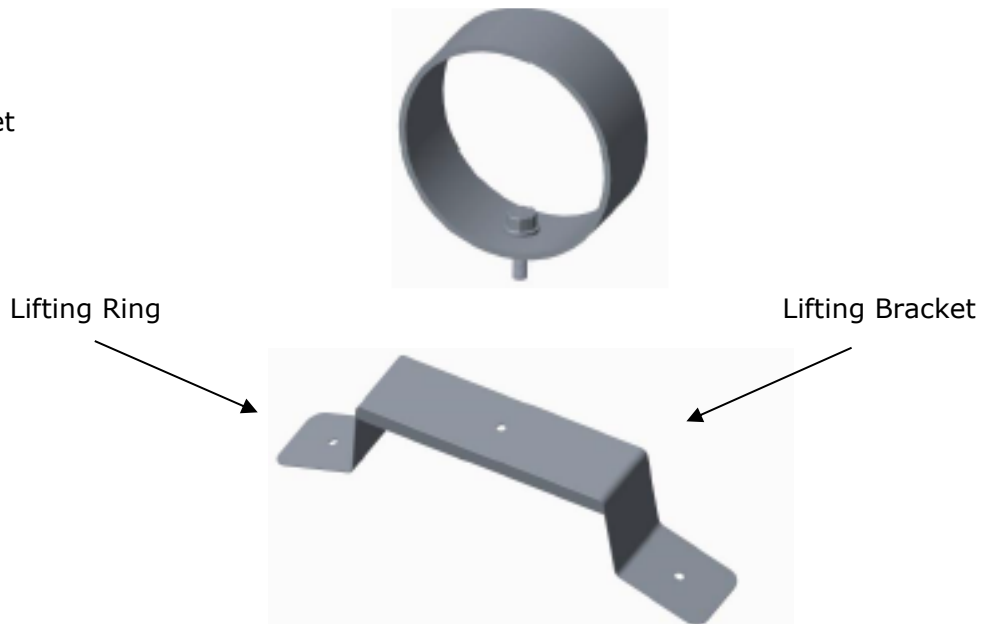



**Hutch is shown transparent for better visual perspective of lifting bracket assembly.**

Lifting bracket mounts on inside of hutch.

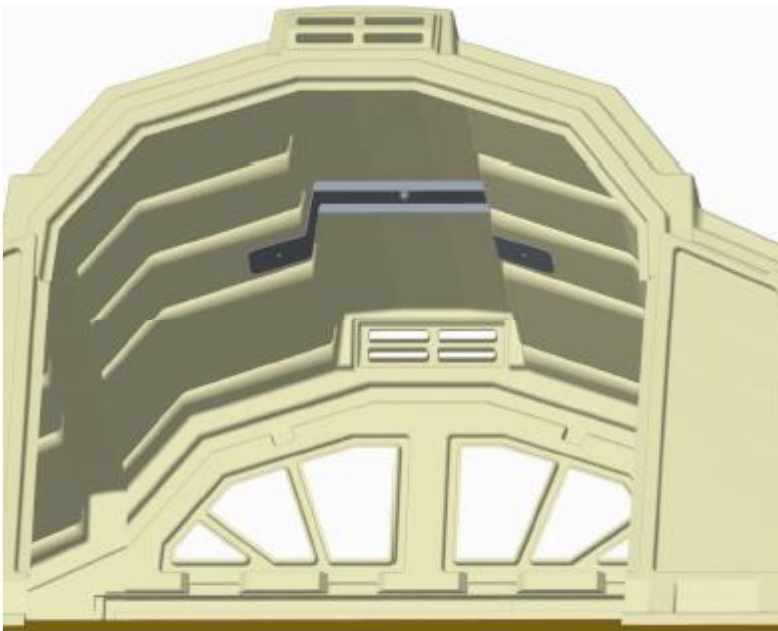
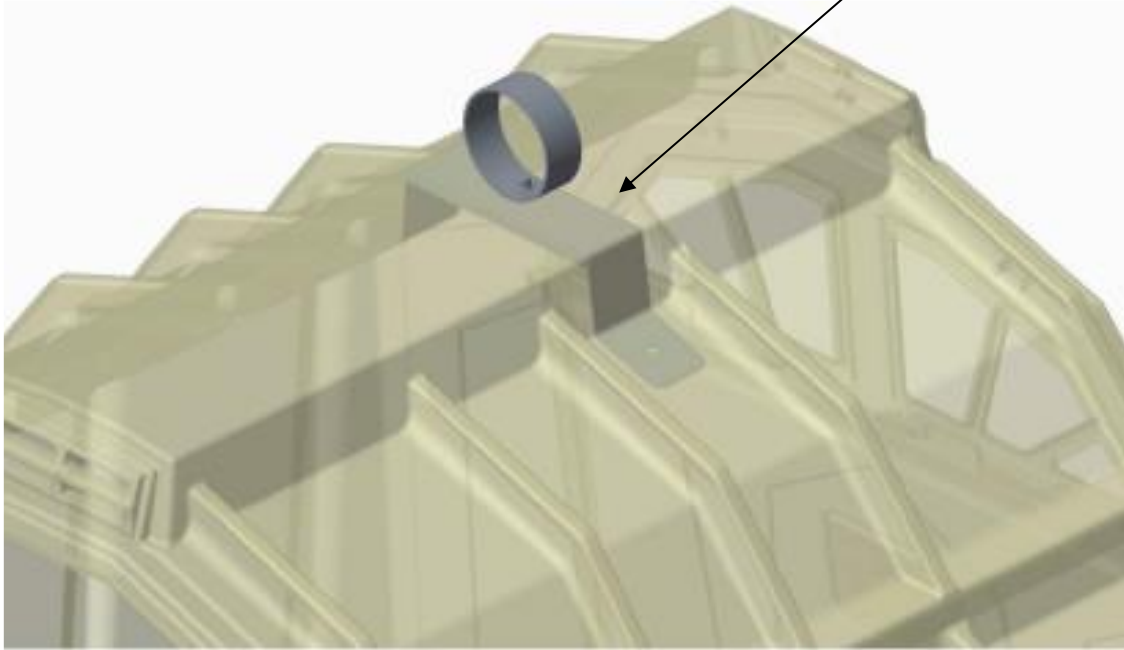

Looking from inside the hutch, drill the center hole in roof measuring 26.50" from back inside roof edge. Then, drill the other 2 holes using a 9/16 drill.

**Note:** The bracket can be used as a drill guide as it conforms to the shape of the inside of the roof.

Revised October 2021



Assemble the lifting ring and bracket together using the supplied hardware kit (CT-HDWE-004).

