



# CT-6191 Pen Wall Attachment Assembly Instructions

## CT-6191 Pen Wall Attachment System Bill of Materials:

Item	Item Number	Description	Qty
1	CT-6191	Pen Wall Bracket	1
2	CT-HDWE-003	1/4 x 2.5" Lag Screw	3

### Tools Needed:

- 5/16" Socket

Using (3) CT-HDWE-003 LAG screws, anchor wall bracket to wall.

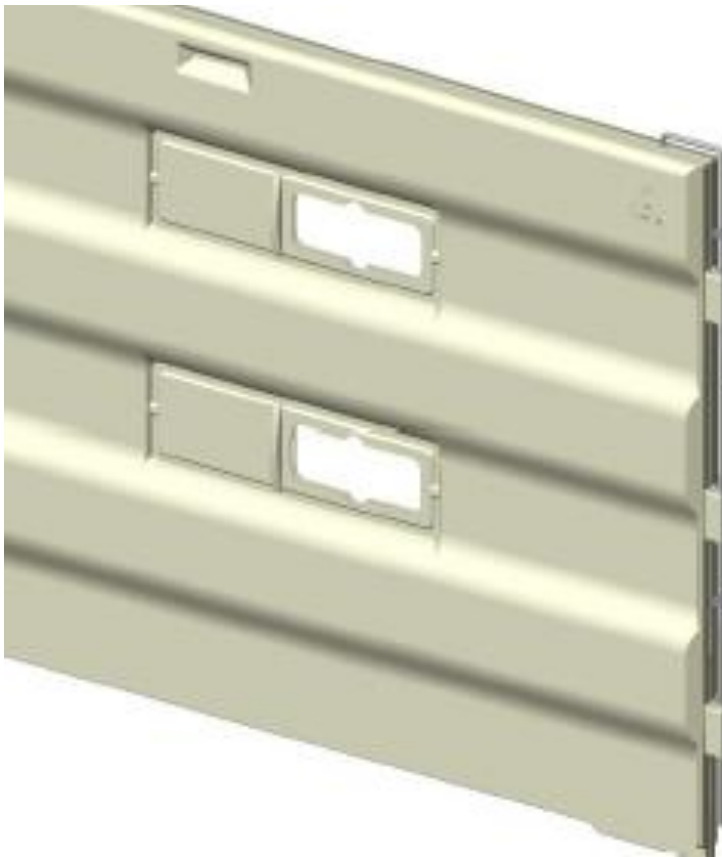
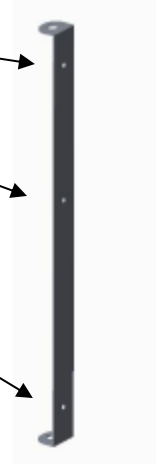

Bottom of bracket is mounted 17.0" up from floor.

Panel brackets are to be mounted on 46.25" centers.

## Attaching the CT-6305 Upright to Door Frame

Follow the same procedure as the front upright and align the top upright tab under the top rear panel knuckle.

Slide the hinge rod down aligning the tabs with the panel knuckles.

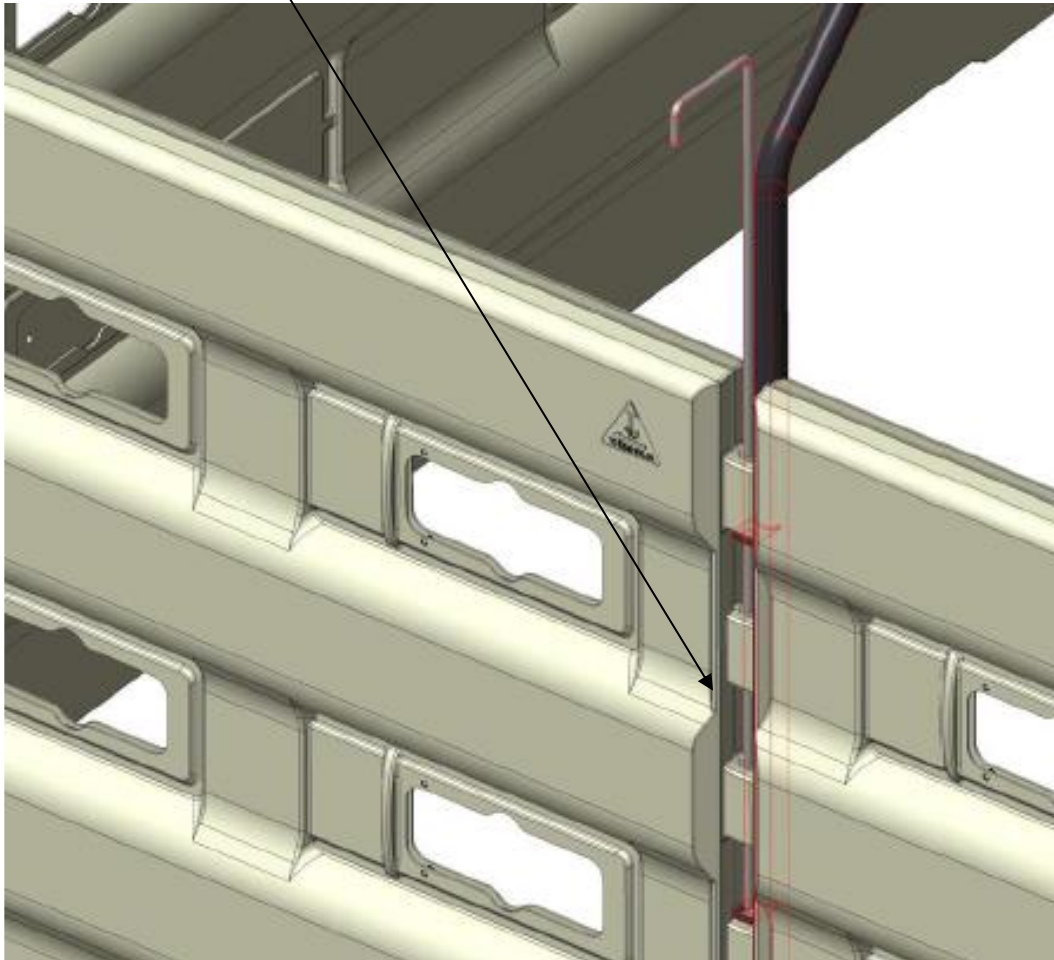

## Attaching the CT-6315 Crossover to Uprights

Slide the top crossover section over each upright.

Using the provided screws, fasten the top crossover to the front and back upright.

**Note:** The screw used for fastening the upright to the top crossover comes pre-installed into the upright. You will need to back the screw out using a 5/16 ratchet, assemble the upright and crossover, and then fasten together.

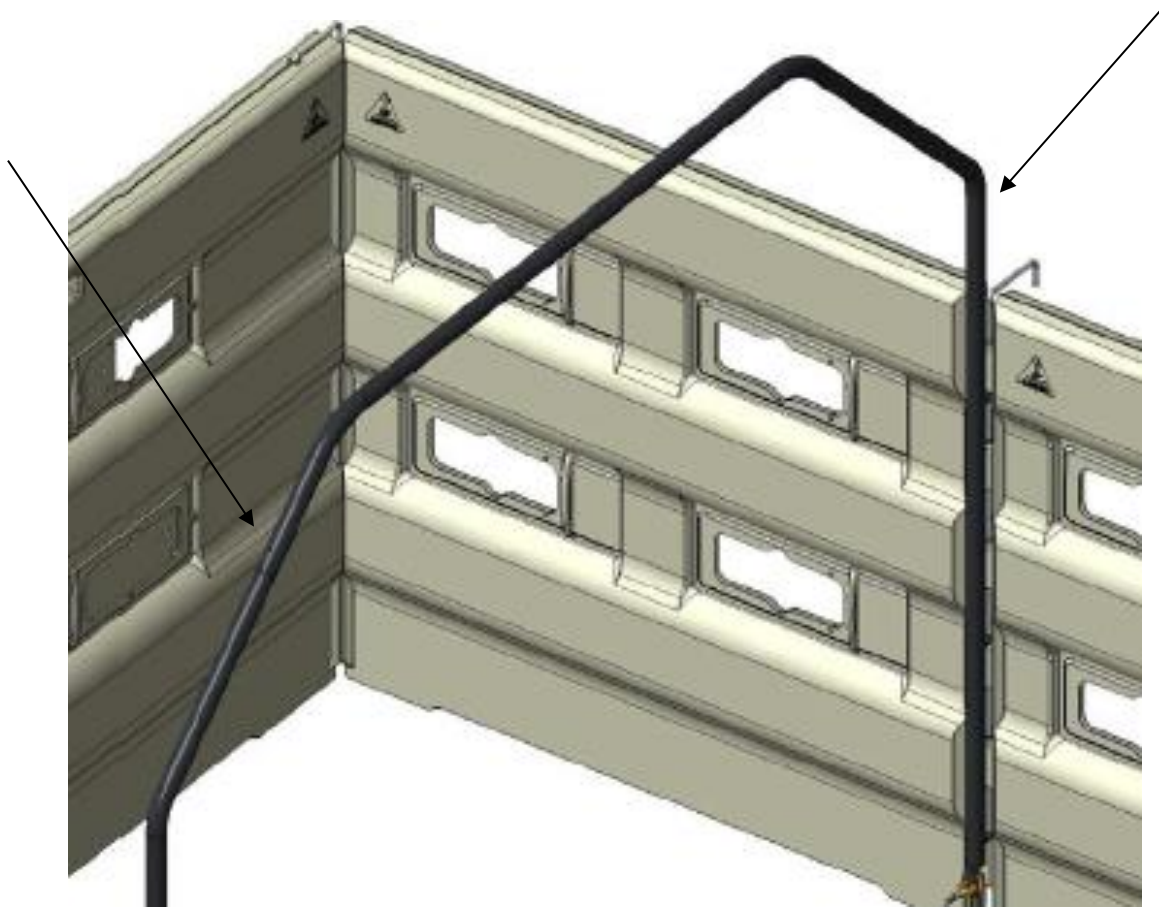



## Attaching the CT-6310/CT-6320 Tether Assembly to Uprights

**Note:** The tether and mounting hardware will come already assembled. You will need to take the nut and washers off to assemble the eyebolt to the uprights.

Assemble the tether with the nut and washers on the inside of both uprights as shown below.

