



# **CT-4000-P2 & CT-4020-P2** **Elite Pairing Fence** **For 24|74 and 35|85 Calf-Tel Hutch** **Assembly Instructions for Installation**



## **CT-4000-P2 Calf-Tel Elite Pairing Fence for 24|74 Bill of Material:**

| Item | Item Number | Description                | Qty |
|------|-------------|----------------------------|-----|
| 1    | CT-4001     | 24 74 Elite Front Frame    | 2   |
| 2    | CT-4002     | Elite Side Panel           | 2   |
| 3    | CT-4004     | Elite Corner Bracket       | 4   |
| 4    | CT-4005     | Center Front               | 1   |
| 5    | CT-4006     | Elite Pairing Pipe 1       | 1   |
| 6    | CT-4007     | Elite Pairing Pipe 2       | 1   |
| 7    | CT-4008     | Elite Pairing Flip-Up      | 1   |
| 8    | CT-4009     | Gap Filler Bracket-Right   | 2   |
| 9    | CT-4010     | Gap Filler Bracket-Left    | 2   |
| 10   | CT-4011     | Elite Fence Legs           | 2   |
| 11   | CT-4013     | Gate Latch                 | 2   |
| 12   | CT-9006     | Gate                       | 2   |
| 13   | CT-HDWE-051 | Elite Pairing Hardware Kit | 1   |

## **CT-4020-P2 Calf-Tel Elite Pairing Fence for 35|85 Bill of Material:**

| Item | Item Number | Description                | Qty |
|------|-------------|----------------------------|-----|
| 1    | CT-4021     | 35 85 Elite Front Frame    | 2   |
| 2    | CT-4002     | Elite Side Panel           | 2   |
| 3    | CT-4004     | Elite Corner Bracket       | 4   |
| 4    | CT-4005     | Center Front               | 1   |
| 5    | CT-4022     | Elite Pairing Pipe 1       | 1   |
| 6    | CT-4023     | Elite Pairing Pipe 2       | 1   |
| 7    | CT-4008     | Elite Pairing Flip-Up      | 1   |
| 8    | CT-4009     | Gap Filler Bracket-Right   | 2   |
| 9    | CT-4010     | Gap Filler Bracket-Left    | 2   |
| 10   | CT-4011     | Elite Fence Legs           | 4   |
| 11   | CT-4013     | Gate Latch                 | 2   |
| 12   | CT-9006     | Gate                       | 2   |
| 13   | CT-HDWE-051 | Elite Pairing Hardware Kit | 1   |



**Tools Needed:**

1. ½ in Socket & Ratchet
2. ½ in Open End Wrench
3. Electric Drill
4. 3/8" Drill Bit

**Tips & Tricks:**

1. Open hardware kit and separate bolts into same lengths.
  - a. 2-1/4" length used to attach legs
  - b. 1-1/2" length used to attach corner brackets
  - c. ¾" length used to attach hutch
  - d. 1-1/4" length used to attach latch
2. A C-clamp holding the front frame to side panel helps stabilize the parts while assembling the corners.

**Installation Instructions**

**Step 1: Install Leg(s) to Front Frame:**

24|74 Elite Fence only requires one single leg in the middle of front frame. 35|85 Elite Fence requires two as seen in picture below. Place leg(s) under front frame and connect with hardware. Insert 2-1/4" bolts through the top of the fence bar and tighten with nut on the bottom.

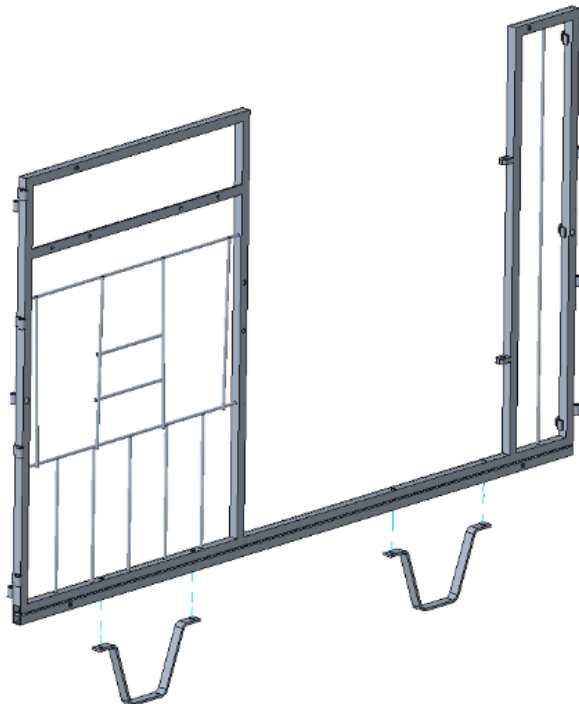



**Step 2: Align Front Frame to Side Panels:** The pin on the side panel aligns to the hole in the front frame. This helps position the front frame and side panels for corner connections in the next step.

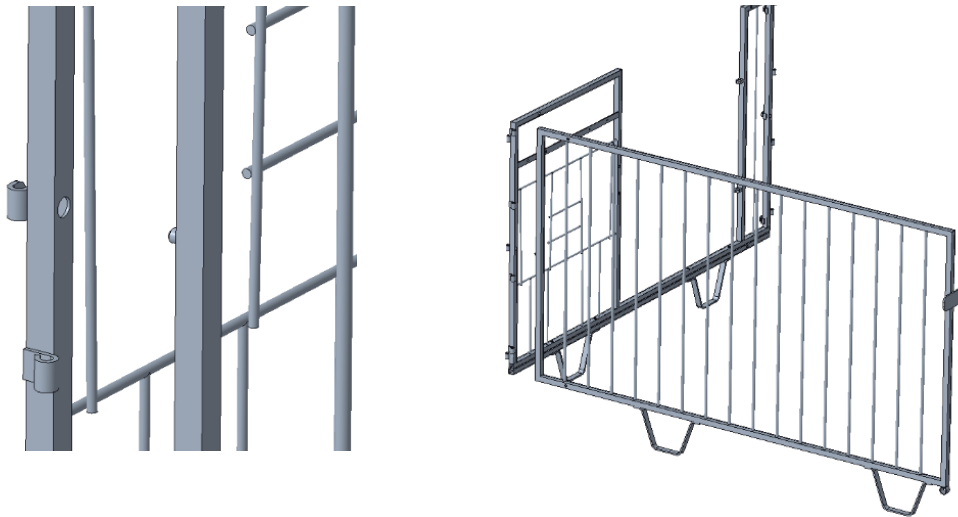

**Step 3: Secure Front Frame to Side Panels:** Attach upper and lower corners with corner brackets and 1-1/2" bolts.

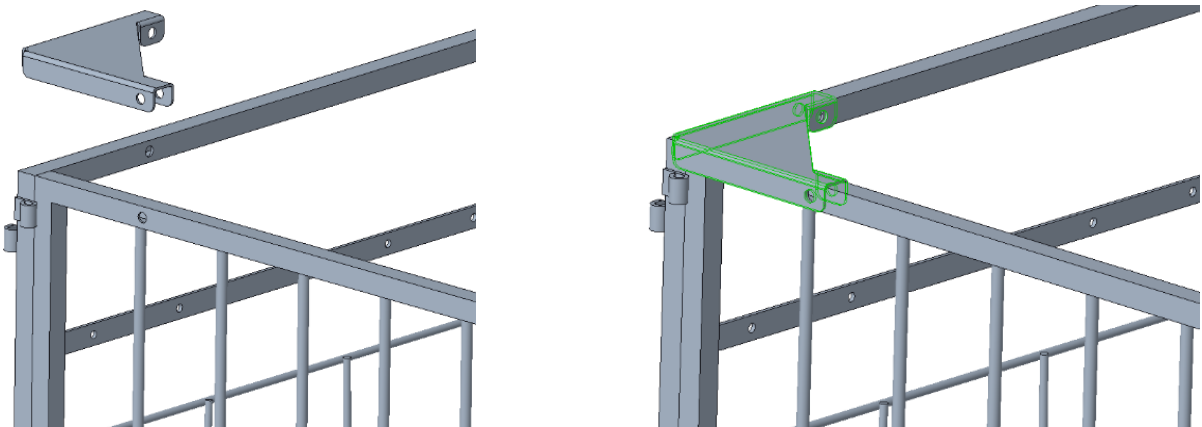

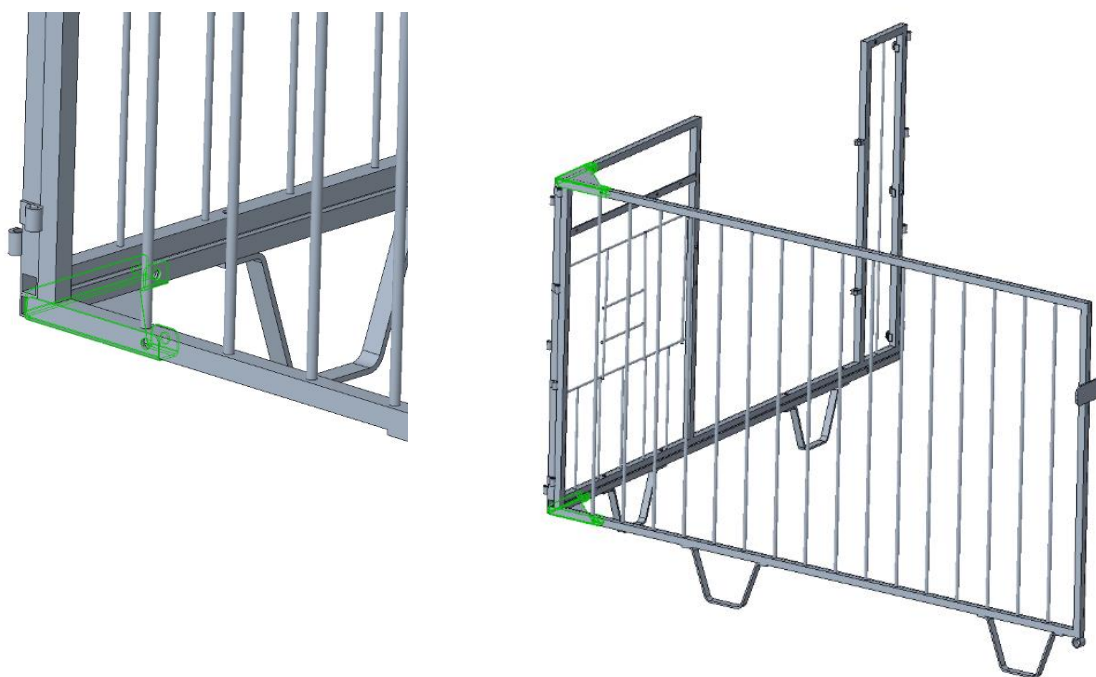

**Step 4:** Connect the Center Front to the opposite side of the front frame of the previous step with 1-1/2" bolts

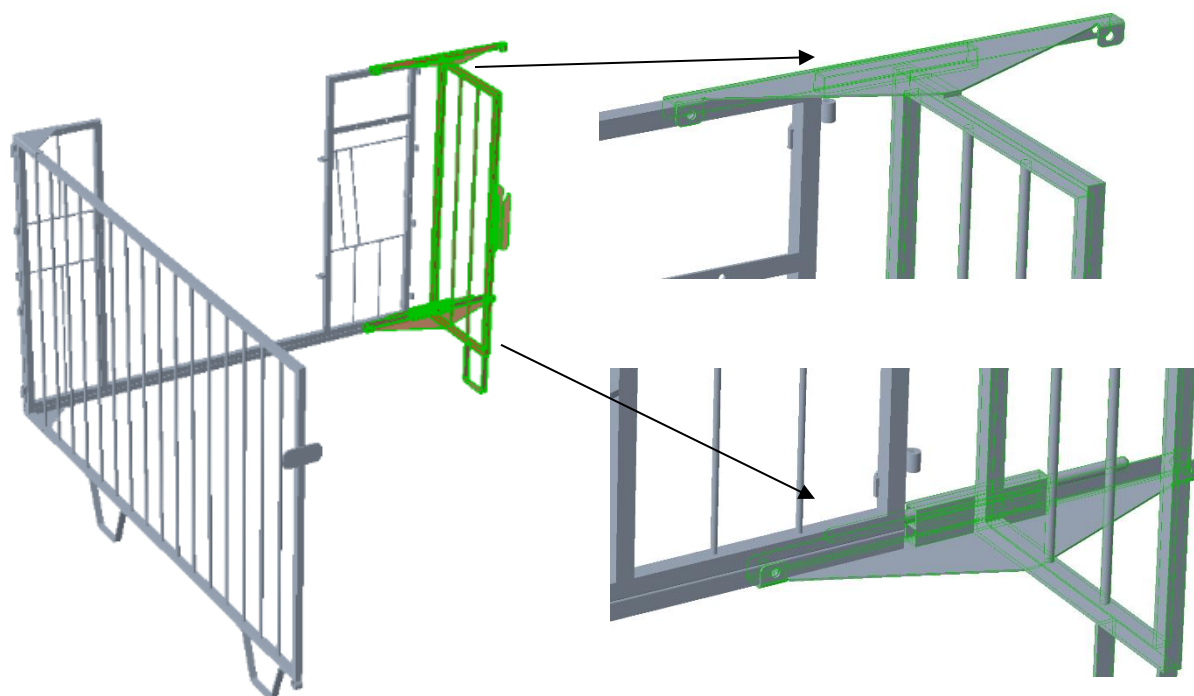



**Step 5:** Connect the Center Front to the opposite side of the front frame of the previous step.

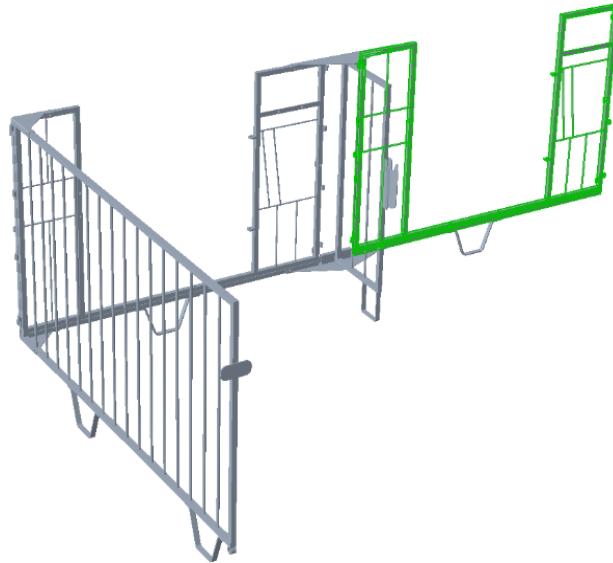

**Step 6: Align Front Frame to Opposite Side Panels – Same as Steps 2 & 3:** The pin on the side panel aligns to the hole in the front frame. This helps position the front frame and side panels for corner connections in the next step. Attach upper and lower corners with corner brackets and 1-1/2" bolts.

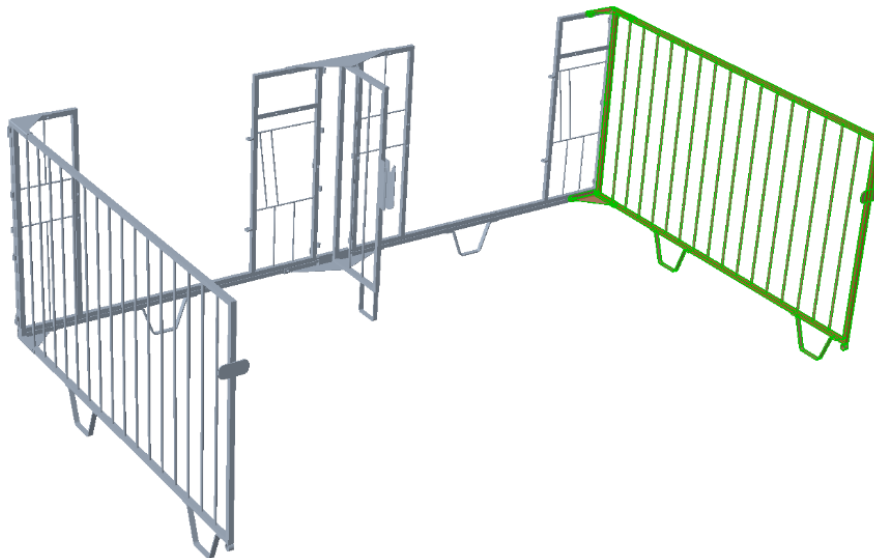



**Step 7:** Insert CT-4007 pipe into bottom back of the side panel.

**Step 8:** Slide hutch connection pieces on to each side of 1<sup>st</sup> pipe.

**Step 9:** Double check that hutch connection pieces face toward where the hutch will sit.

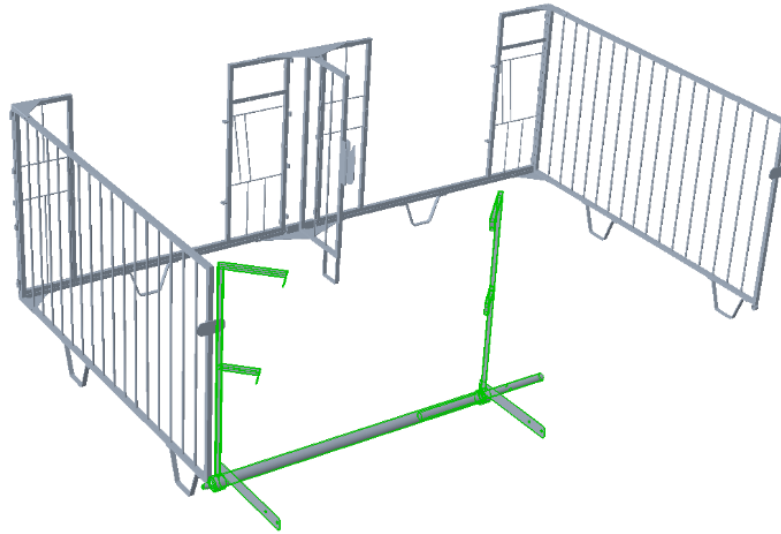

**Step 10:** Slide CT-4008 Center Flip up over the end of the 1<sup>st</sup> pipe.

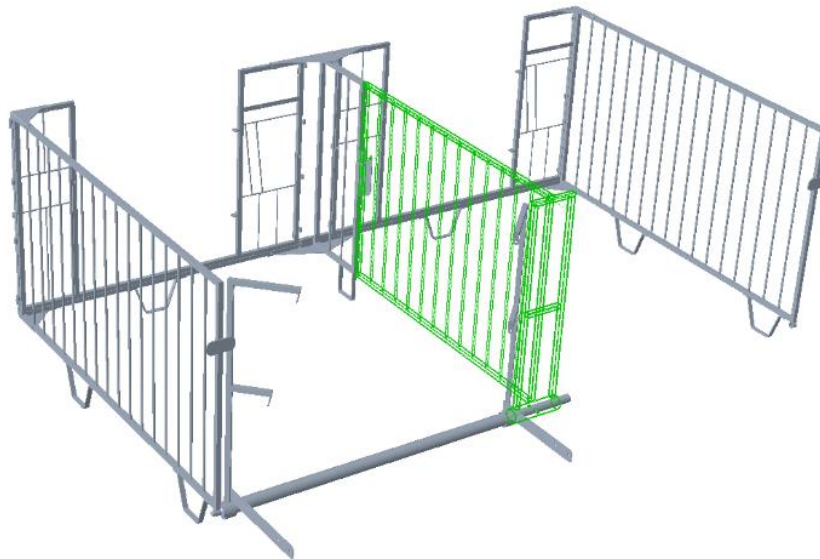



**Step 11:** Insert CT-4006 pipe into bottom back of the side panel.

**Step 12:** Slide hutch connection pieces on to each side of 2nd pipe.

**Step 13:** Double check that hutch connection pieces face toward where the hutch will sit.

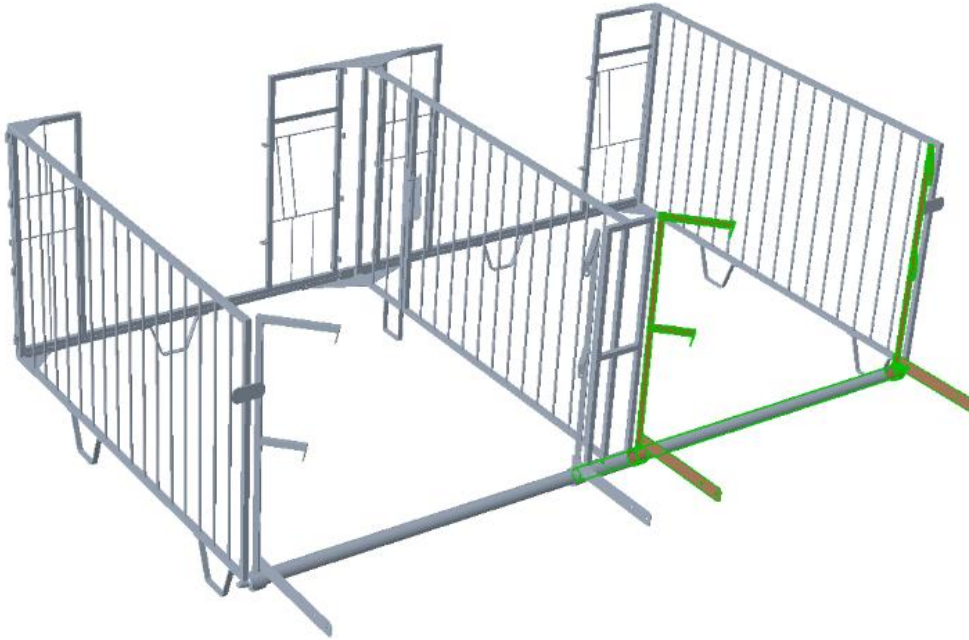

**Step 14:** Align the thru holes at the bottom of the center flip up and both pipes and connect with the 3.5" bolt.

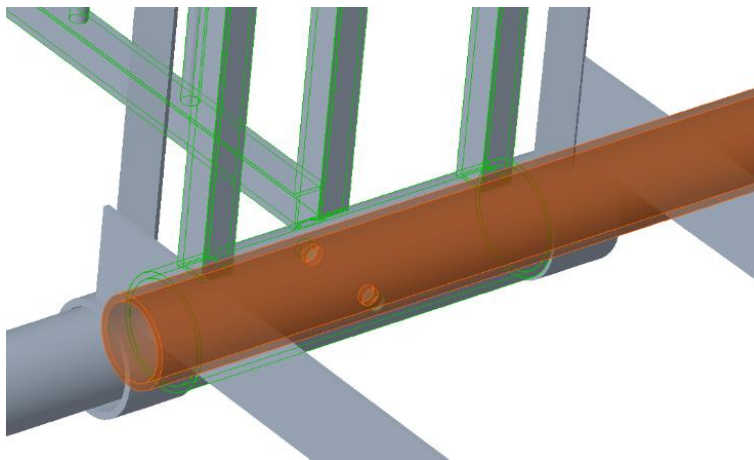





**Step 15:** Pin pipe ends in place.

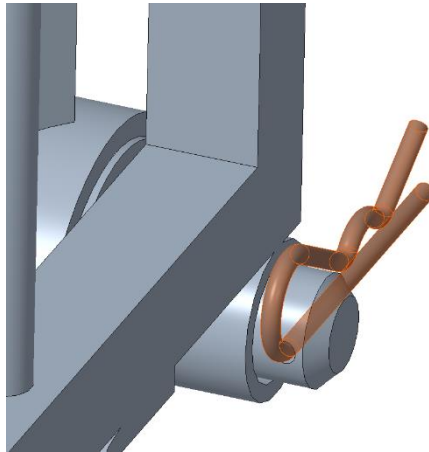

**Step 16:** Push hutch up to fence.

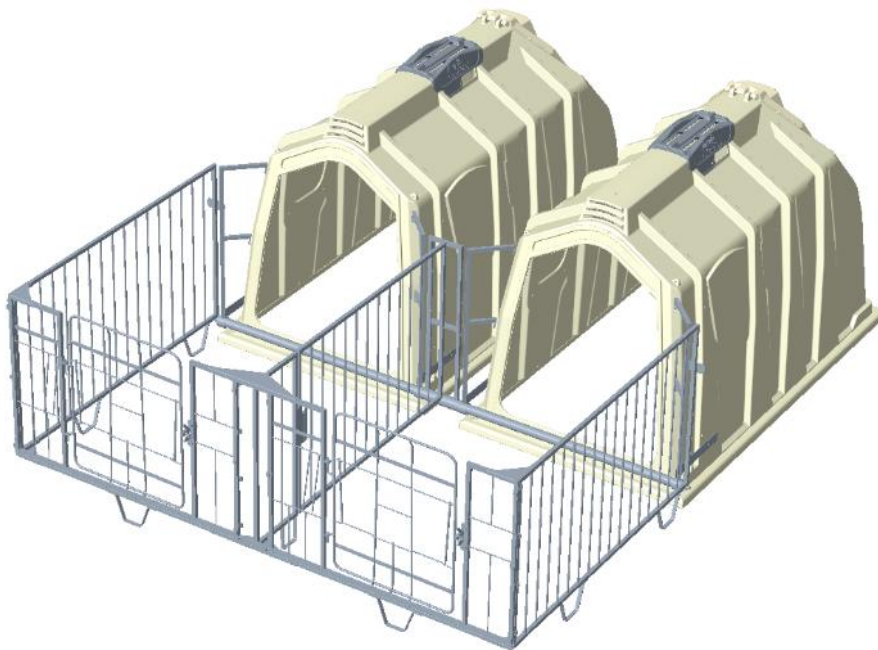





**Step 17:** Align hutch connectors to angle front corner surfaces.

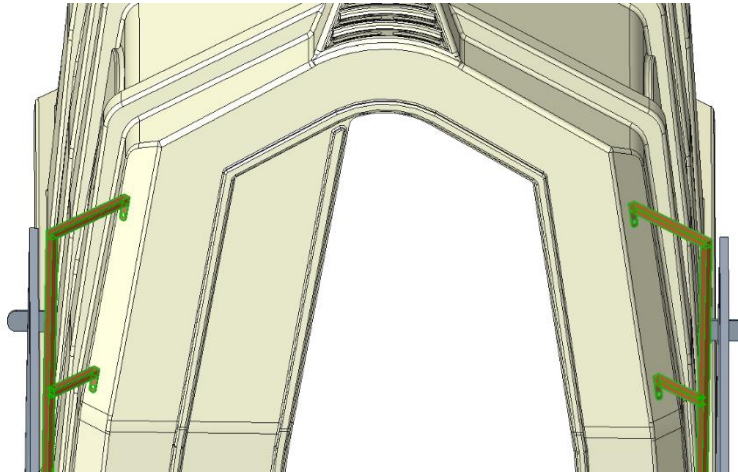

**Step 18:** Using a marking device, mark the hutch through the holes on the tabs of the hutch connection pieces. Also, mark the hutch through the 2 holes on the lower support bar of the hutch connection pieces.

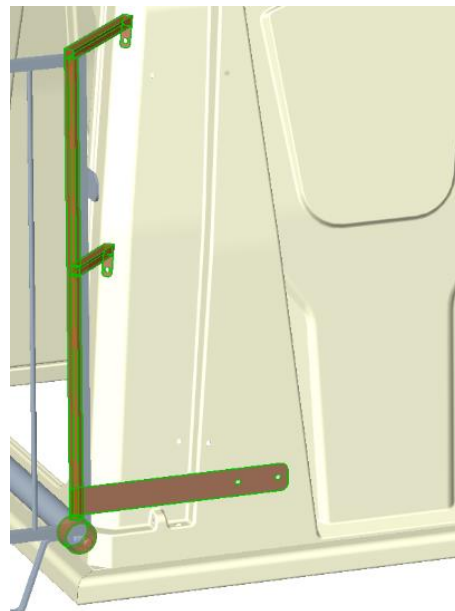
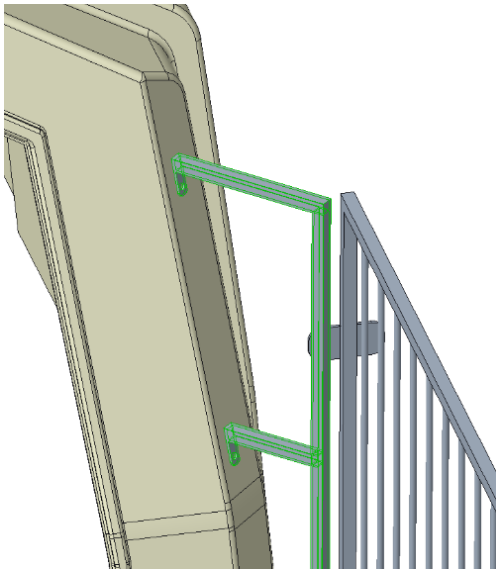

**Step 19:** Using the marks, drill holes into the hutch with a 3/8" drill bit.



**Step 20: Attach Fence to Hutch:** Align top and bottom support bars with holes and using  $\frac{3}{4}$ " bolts, attach fence to hutch. Bolts should be inserted from the inside and secured with nut on outside. This prevents calf from potentially rubbing up against screw and injuring itself.

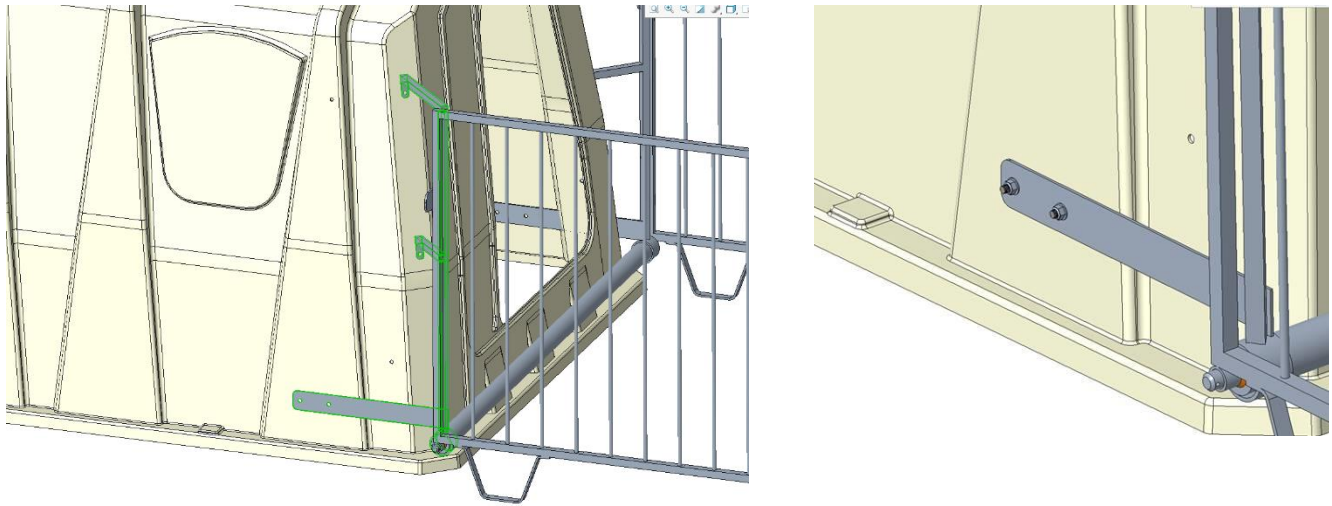

**Step 21: Connect Latch to Frame:** Using 1-1/4" length bolt, attach gate latch to front frame.

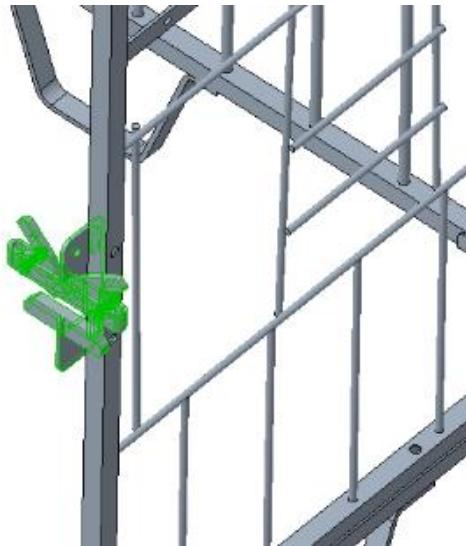



**Step 22: Place Gate on Frame:** Start by guiding top bar through frame hole. Then, guide bottom bar through lower frame hole.

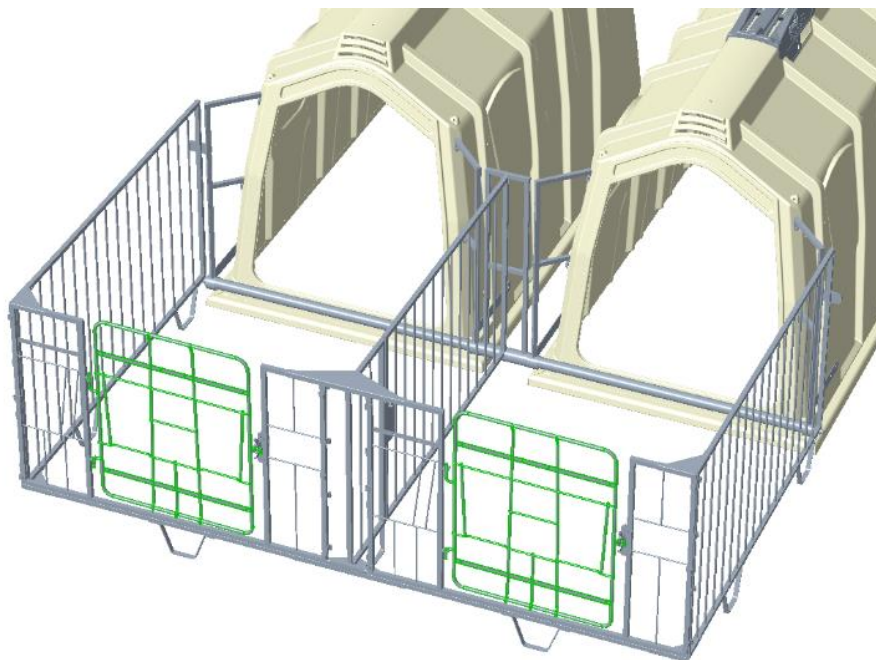
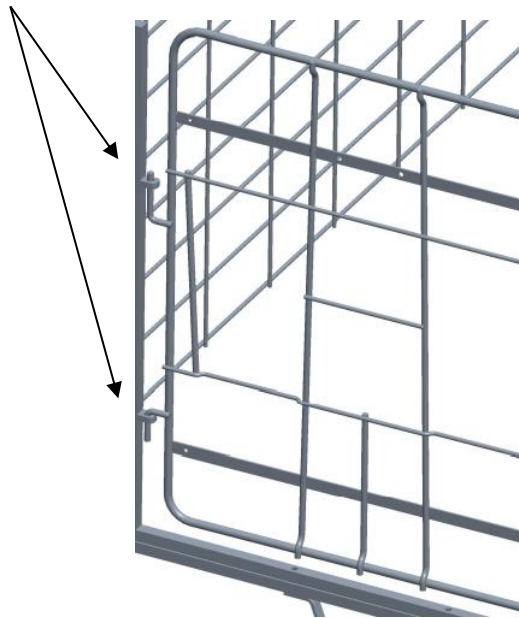



## Elite Pairing Fence for 24|74 Parts Diagram

| Index # | Part #  | Description                           | Qty |
|---------|---------|---------------------------------------|-----|
| 1       | CT-4006 | FENCE, PIPE 1, ELITE PAIRING, 24/74   | 1   |
| 2       | CT-4007 | FENCE, PIPE 2, ELITE PAIRING 24/74    | 1   |
| 3       | CT-4002 | FENCE, SIDE PANEL, ELITE              | 2   |
| 4       | CT-4009 | FENCE, GAP FILLER, HUTCH RIGHT, ELITE | 2   |
| 5       | CT-4010 | FENCE, GAP FILLER, HUTCH LEFT, ELITE  | 2   |
| 6       | CT-4008 | FENCE, FLIPUP, ELITE PAIRING          | 1   |
| 7       | CT-4001 | FENCE, FRONT FRAME, ELITE, 24/74      | 2   |
| 8       | CT-4005 | FENCE, CENTER FRONT, ELITE PAIRING    | 1   |
| 9       | CT-9006 | FENCE, GATE, ELITE                    | 2   |
| 10      | CT-4004 | FENCE, CORNER BRACKET, ELITE          | 4   |
| 11      | CT-4011 | FENCE, LEG, ELITE                     | 2   |
| 12      | CT-4013 | FENCE, GATE LATCH, ELITE, IN/OUT      | 2   |

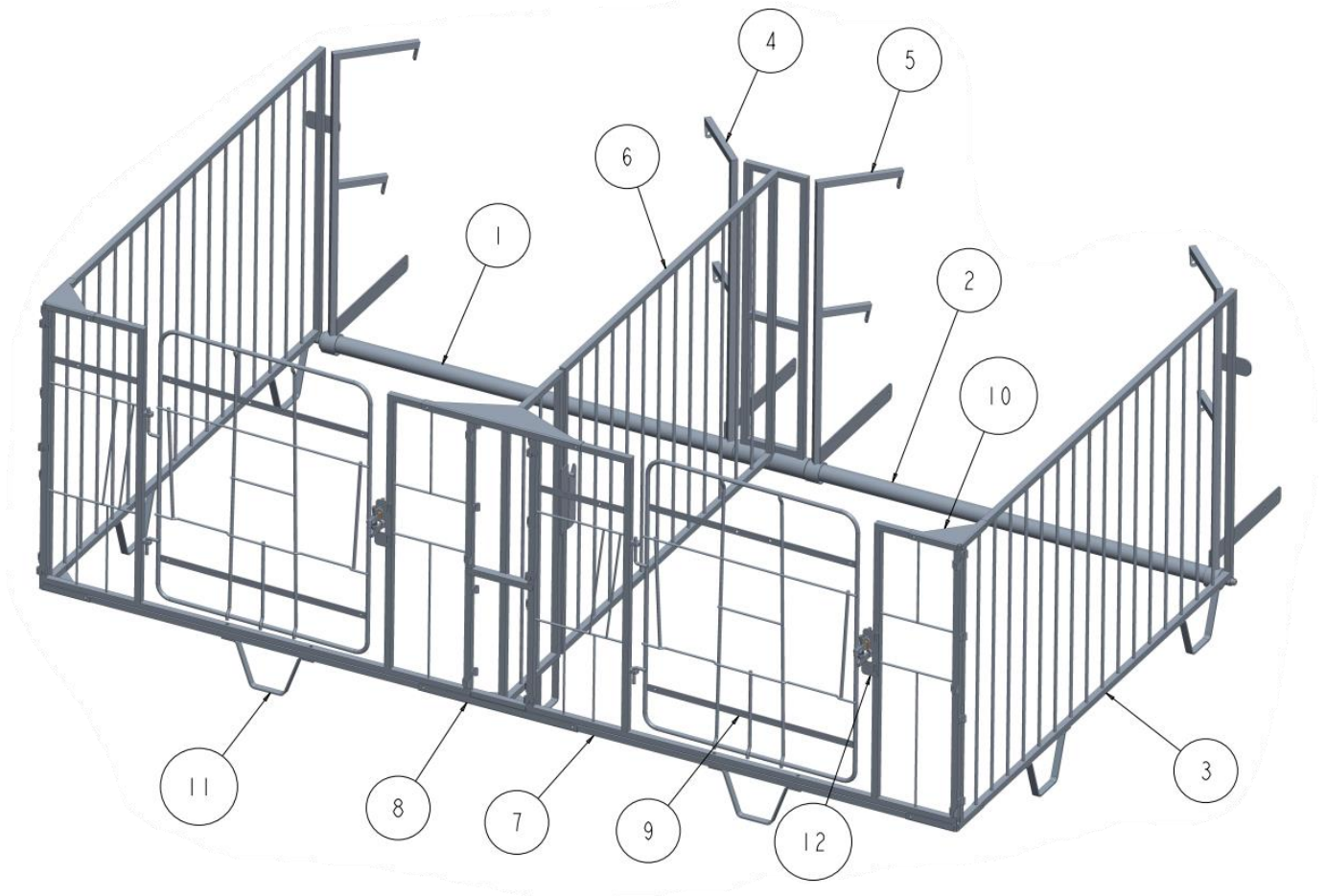





## Elite Pairing Fence for 35|85 Parts Diagram

| Index # | Part #  | Description                           | Qty |
|---------|---------|---------------------------------------|-----|
| 1       | CT-4005 | FENCE, CENTER FRONT, ELITE PAIRING    | 1   |
| 2       | CT-4004 | FENCE, CORNER BRACKET, ELITE          | 4   |
| 3       | CT-4008 | FENCE, FLIPUP, ELITE PAIRING          | 1   |
| 4       | CT-4021 | FENCE, FRONT FRAME, HD 35/85          | 2   |
| 5       | CT-4010 | FENCE, GAP FILLER, HUTCH LEFT, ELITE  | 2   |
| 6       | CT-4009 | FENCE, GAP FILLER, HUTCH RIGHT, ELITE | 2   |
| 7       | CT-4013 | FENCE, GATE LATCH, ELITE, IN/OUT      | 2   |
| 8       | CT-9006 | FENCE, GATE, ELITE                    | 2   |
| 9       | CT-4011 | FENCE, LEG, ELITE                     | 4   |
| 10      | CT-4022 | FENCE, PIPE 1, ELITE PAIRING 35/85    | 1   |
| 11      | CT-4023 | FENCE, PIPE 2, ELITE PAIRING, 35/85   | 1   |
| 12      | CT-4002 | FENCE, SIDE PANEL, ELITE              | 2   |

