



CT-4000 & CT-4020 **Elite Fence** **For 24|74 and 35|85 Calf-Tel Hutch** **Assembly Instructions for Installation**



CT-4000 Calf-Tel Elite Fence for 24|74 Bill of Material:

Item	Item Number	Description	Qty
1	CT-4002	Elite Side Panel	2
2	CT-4004	Elite Corner Brackets	4
3	CT-4009	Gap Filler Bracket-Right	1
4	CT-4010	Gap Filler Bracket-Left	1
5	CT-4011	Elite Fence Leg	1
6	CT-4013	Gate Latch	1
7	CT-4001	24 74 Elite Front Frame	1
8	CT-4012	24 74 Elite Pipe	1
9	CT-9006	Gate	1
10	CT-HDWE-050	24 74 Elite Fence Hardware Kit	1

CT-4020 Calf-Tel Elite Fence for 35|85 Bill of Material:

Item	Item Number	Description	Qty
1	CT-4002	Elite Side Panel	2
2	CT-4004	Elite Corner Brackets	4
3	CT-4009	Gap Filler Bracket-Right	1
4	CT-4010	Gap Filler Bracket-Left	1
5	CT-4011	Elite Fence Legs	2
6	CT-4013	Gate Latch	1
7	CT-4021	35 85 Elite Front Frame	1
8	CT-4024	35 85 Elite Pipe	1
9	CT-9006	Gate	1
10	CT-HDWE-052	35 85 Elite Fence Hardware Kit	1



Tools Needed:

1. ½ in Socket & Ratchet
2. ½ in Open End Wrench
3. Electric Drill
4. 3/8" Drill Bit
5. C-clamp (Optional)

Tips & Tricks:

1. Open hardware kit and separate bolts into same lengths.
 - a. 2-1/4" length used to attach legs
 - b. 1-1/2" length used to attach corner brackets
 - c. ¾" length used to attach hutch
 - d. 1-1/4" length used to attach latch
2. A C-clamp holding the front frame to side panel helps stabilize the parts while assembling the corners.

Installation Instructions

Step 1: Install Leg(s) to Front Frame:

24|74 Elite Fence only requires one single leg in the middle of front frame. 35|85 Elite Fence requires two as seen in picture below. Place leg(s) under front frame and connect with hardware. Insert 2-1/4" bolts through the top of the fence bar and tighten with nut on the bottom.

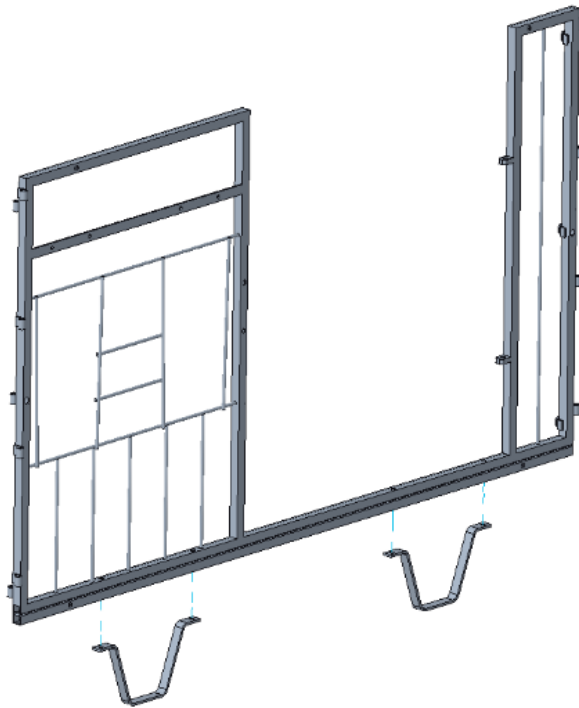



Step 2: Connect Front Frame to Side Panels: Using long pins, insert pins in side panels to the hole in the front frame. This aligns the front frame and side panels for corner connections.

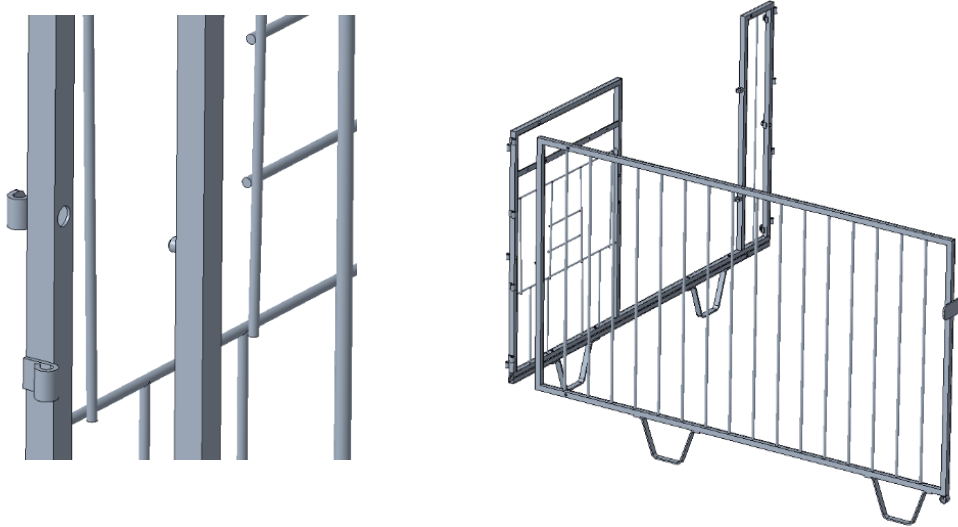

Step 3: Secure Front Frame to Side Panels: Attach upper and lower corners with corner brackets and 1-1/2" bolts.

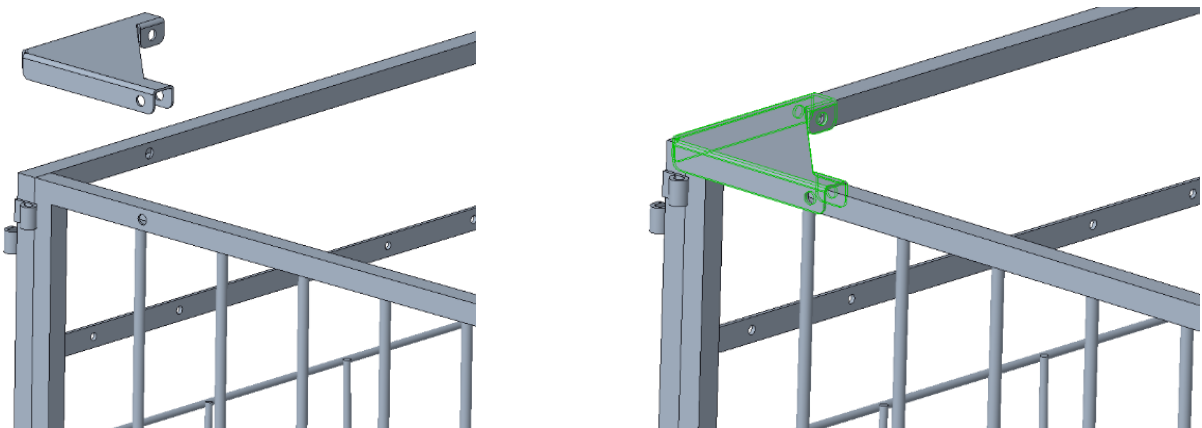

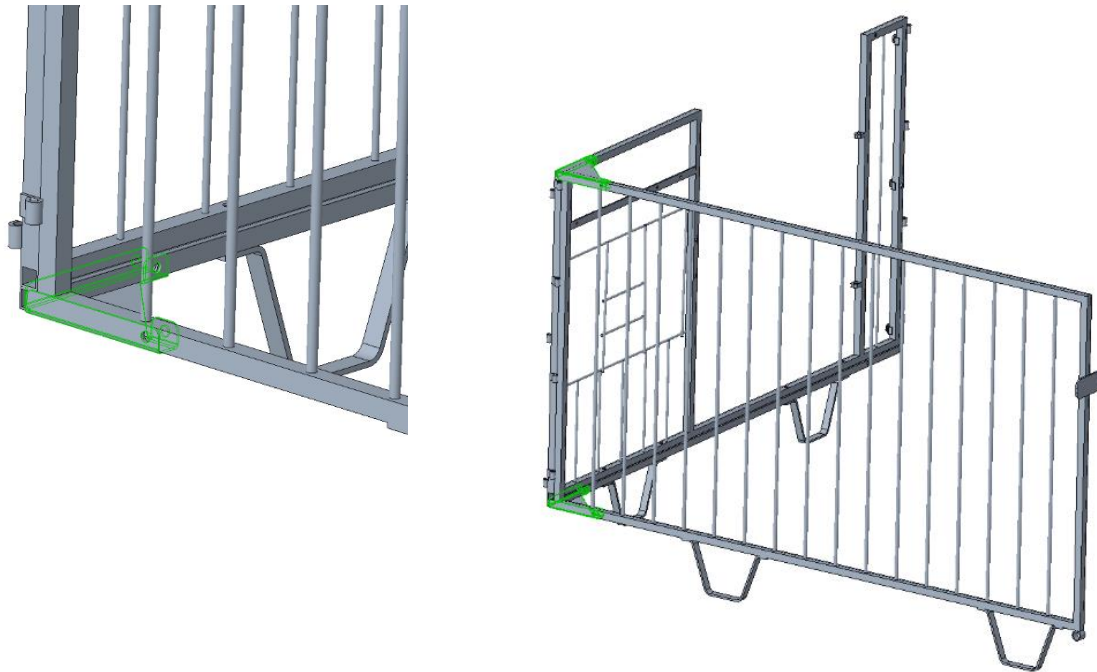

Step 4: Repeat corner connection for opposite side panel.

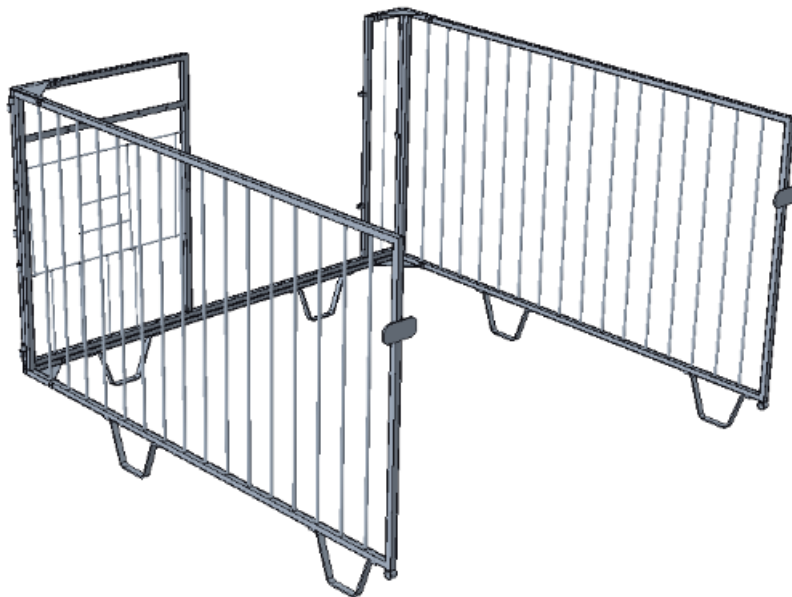



Step 5: Next, find hutch connection pieces and pipe. Position in front of fence on ground. Slide hutch connection pieces on to each side of pipe. Double check that hutch connection pieces face toward where the hutch will sit.

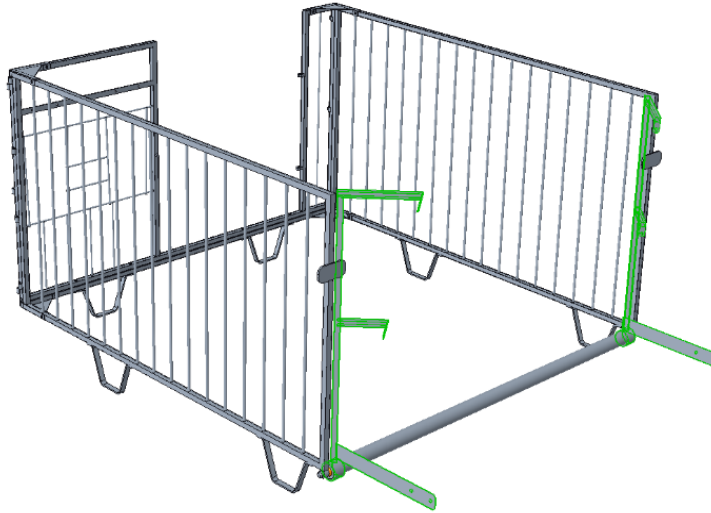

Step 6: Insert pipe into bottom back of side panels.





Step 7: Pin pipe in place.

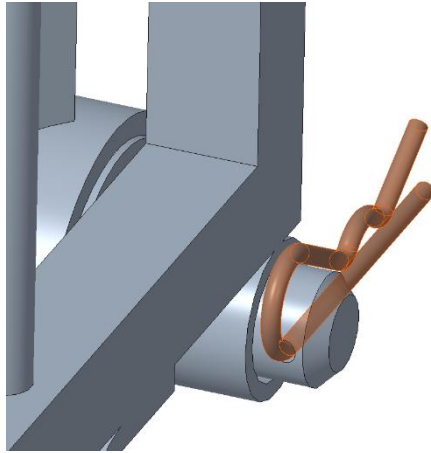

Step 8: Push hutch up to fence.

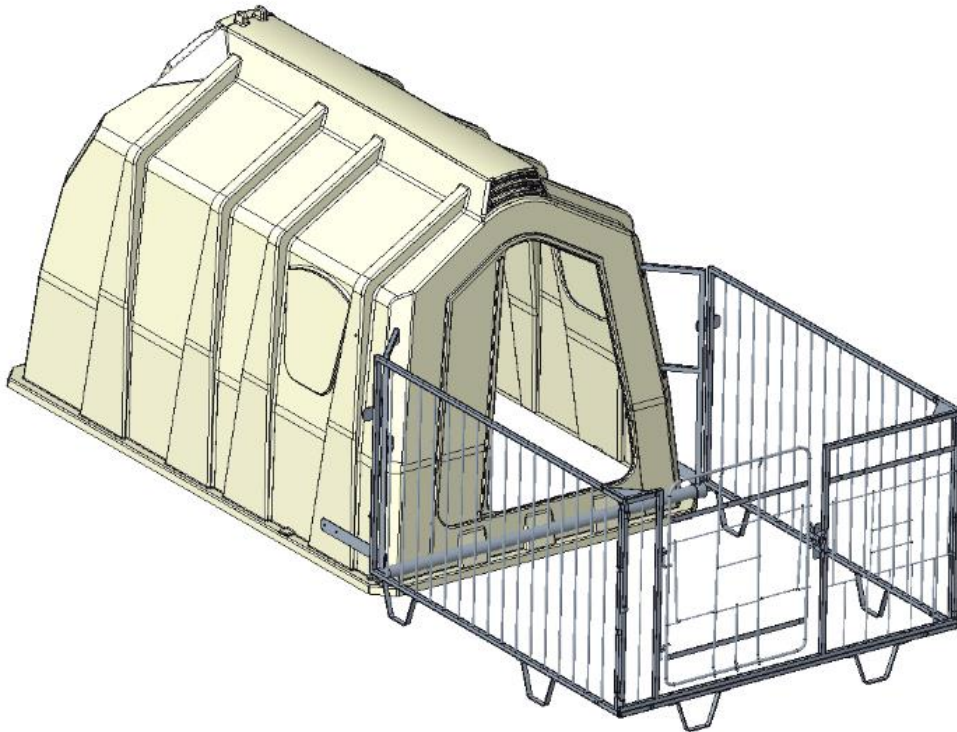



Step 9: Align hutch connectors to angled front corner surfaces.

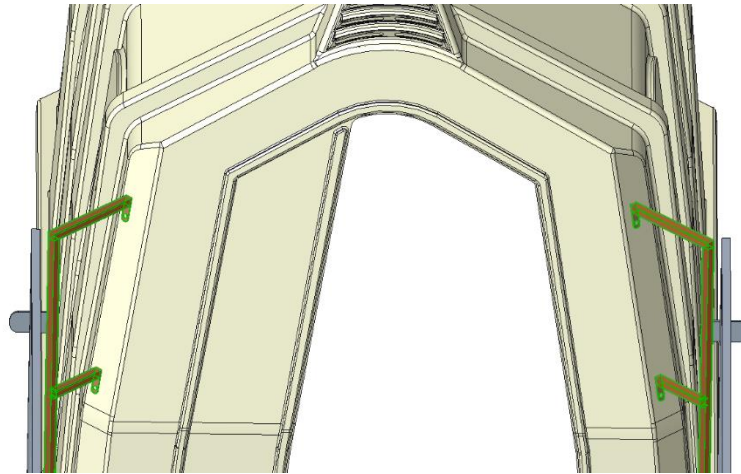

Step 10: Using a marking device, mark the hutch through the holes on the tabs of the hutch connection pieces.

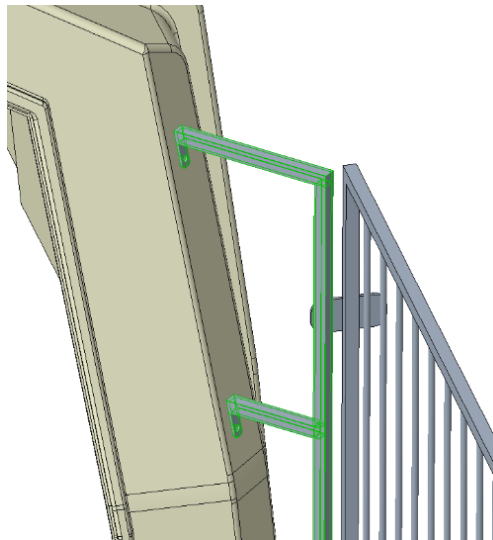

Step 11: Also, mark the hutch through the 2 holes on the lower support bar of the hutch

Step 12: Using the marks, drill holes into the hutch with a 3/8" drill bit.



Step 13: Attach Fence to Hutch: Align top and bottom support bars with holes and using $\frac{3}{4}$ " bolts, attach fence to hutch. Bolts should be inserted from the inside and secured with nut on outside. This prevents calf from potentially rubbing up against screw and injuring itself.

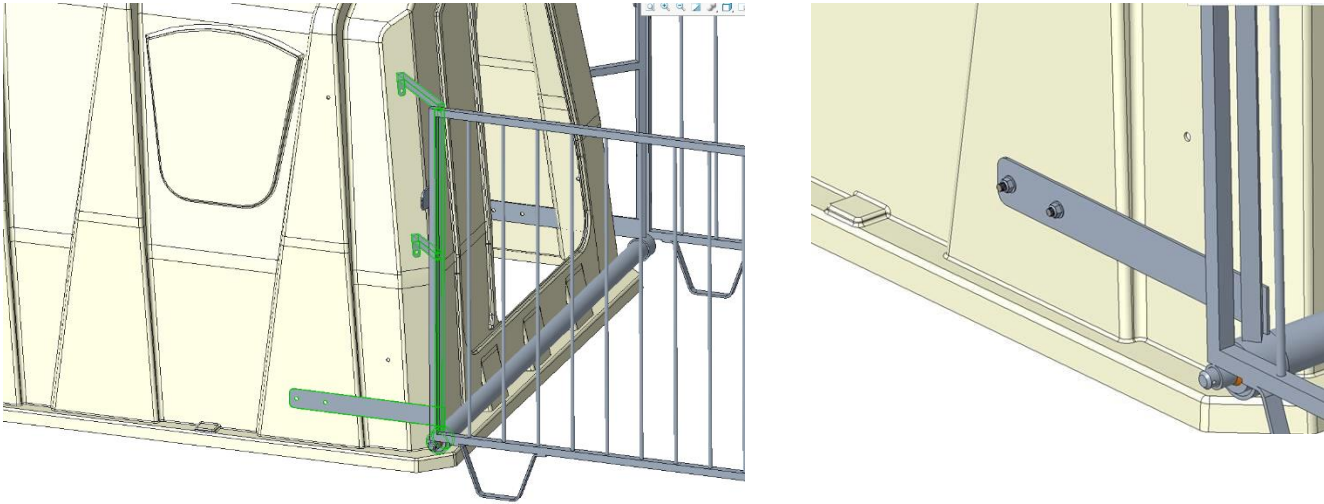

Step 14: Connect Latch to Frame: Using 1-1/4" length bolt, attach gate latch to front frame.

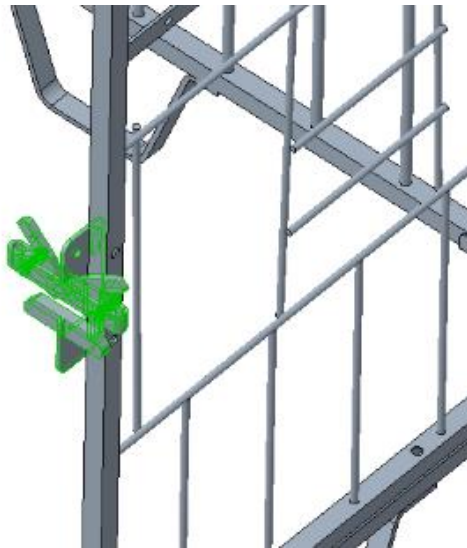



Step 15: Place Gate on Frame: Start by guiding top bar through frame hole. Then, guide bottom bar through lower frame hole.

