

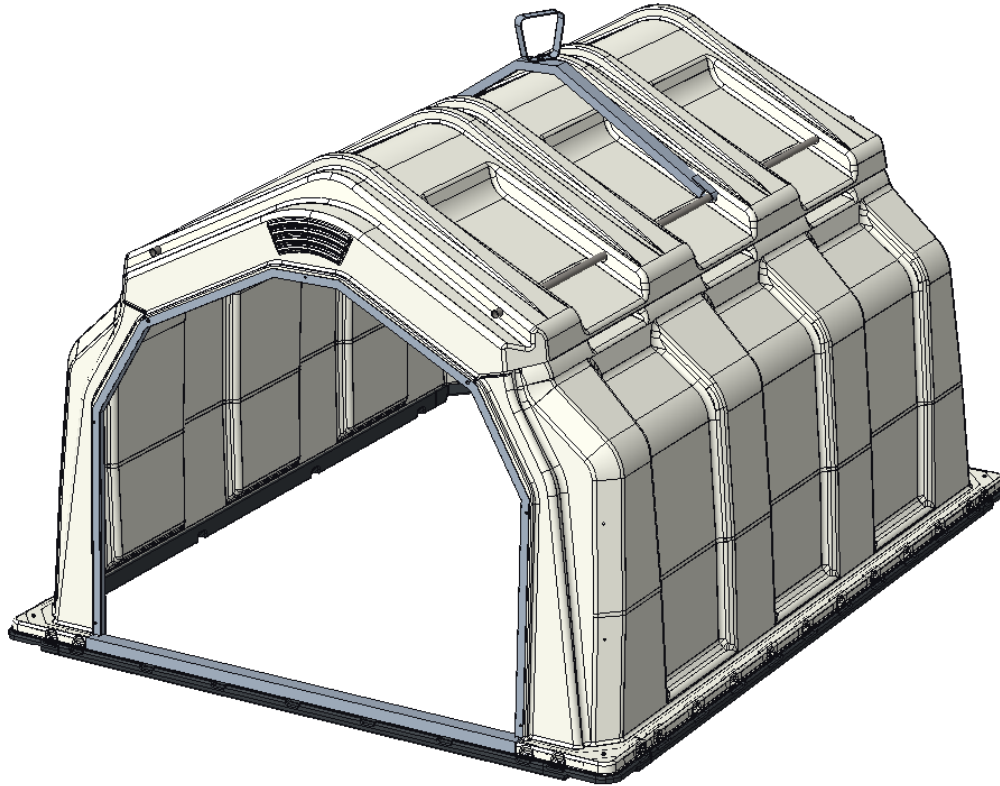

Mammoth Unit

Assembly Instructions

CTG-1000



Bill of Material:

Item	Item Number	Description	Qty
1	CTG-1001	Left Side Panel – Mammoth	1
2	CTG-1002	Right Side Panel – Mammoth	1
3	CTG-1003	Roof - Mammoth	1
4	CTG-1004	Steel Front Frame – Mammoth	1
5	CTG-1005	Back Panel – Mammoth	1
6	CTG-1011	Lifting Device - Mammoth	1
7	CTG-1016	Short Rail Base w/Steel - Mammoth	2
8	CTG-1017	Long Rail Base w/Steel - Mammoth	2
9	CTH-HDWE-018K	Assembly Hardware - Mammoth	1



Tools Needed:

- 1. WE RECOMMEND HAVING 2 PEOPLE FOR ASSEMBLY**
2. 1/2" Socket & Ratchet
3. 1/2" Open End Wrench
4. 3/8" Drill Bit
5. Drill / Impact Driver
6. Rubber Mallet

Assembly:

Step 1: Build the Base Frame

- Locate 1 – CTG-1017 and 1- CTG-1016 base components. Each has a steel pipe insert.



- Connect them at the corner – the steel pipe fits into the corner joint.

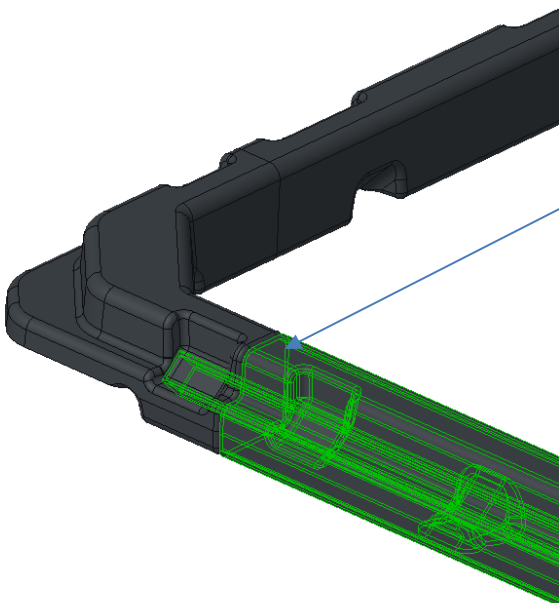

TIP:
Use a drywall screw temporarily to hold the pieces in place while you assemble the rest.



Step 2: Complete the Base

- Repeat Step 1 with the other rail components (CTG-1017 & CTG-1016) to make the completed base.
- Form a rectangle with internal dimensions to help keep the base in the correct size:
 - **Long Side:** 132-5/8" (336.87 cm)
 - **Short Side:** 109-7/8" (279.08cm)

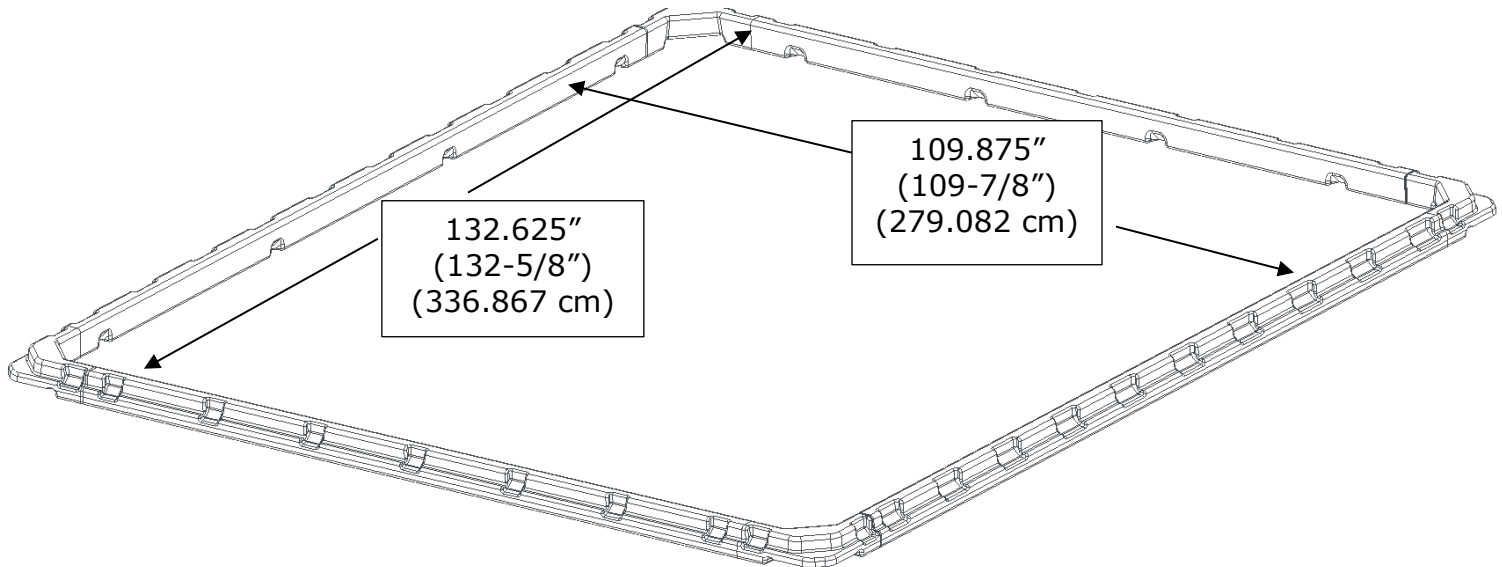

Step 3: Attach Left Side Panel

- Set the CTG-1001 – Left Side Panel on the base rail.
- Align the molded features on the panel with the base.

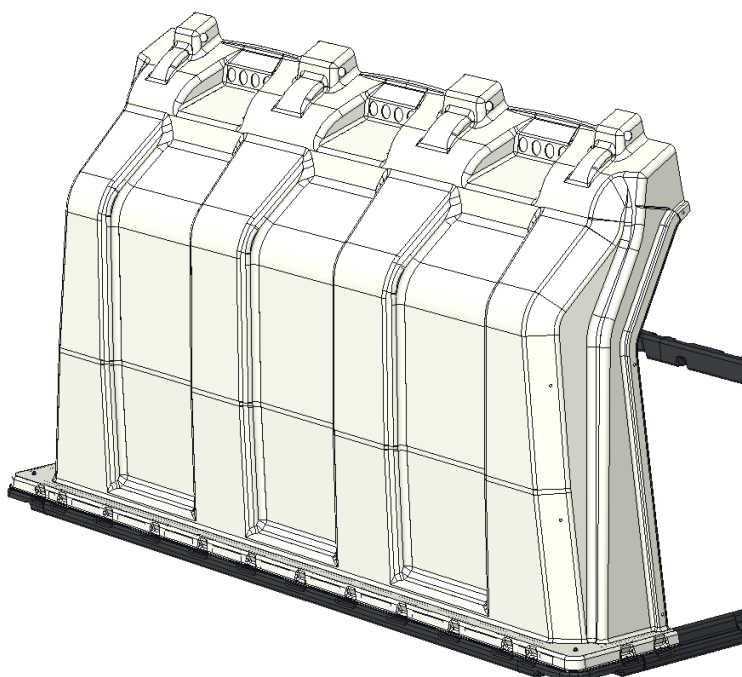

- Use **self-drilling screws and washers** (from the hardware kit) to secure it.
- Use a 1/2" socket with your impact driver.

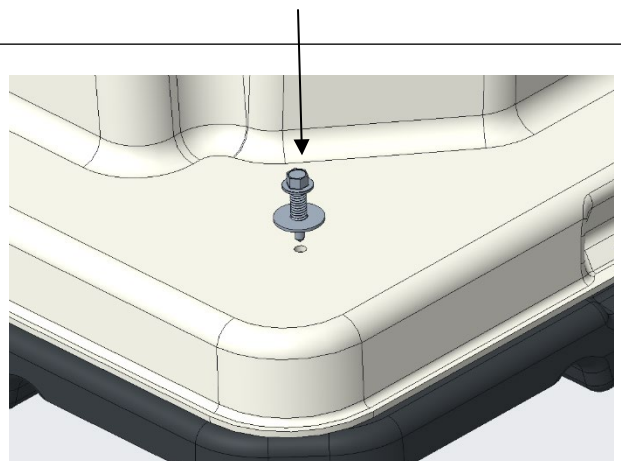



Step 4: Install the Back Panel

- Slide the CTG-1001 **Left Side Panel** Edge between the CTG-1005 **Back Panel Surfaces**

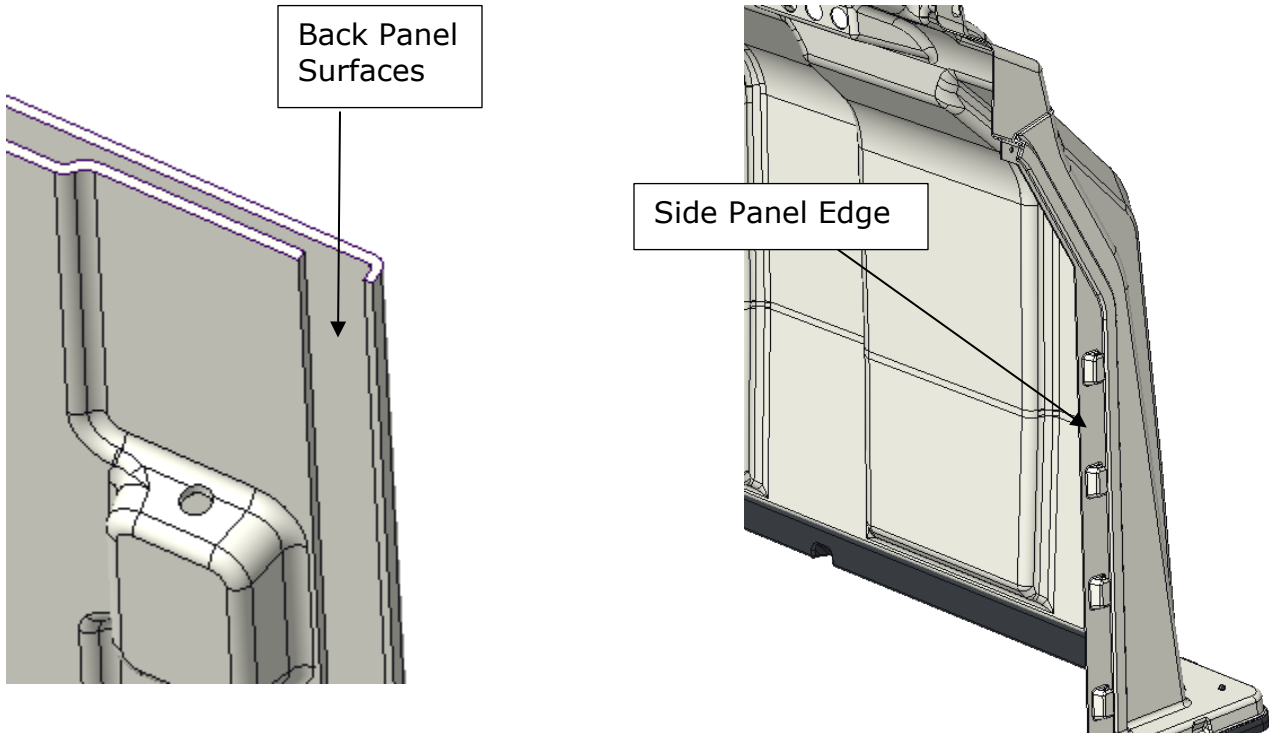

- Push firmly to snap them into place

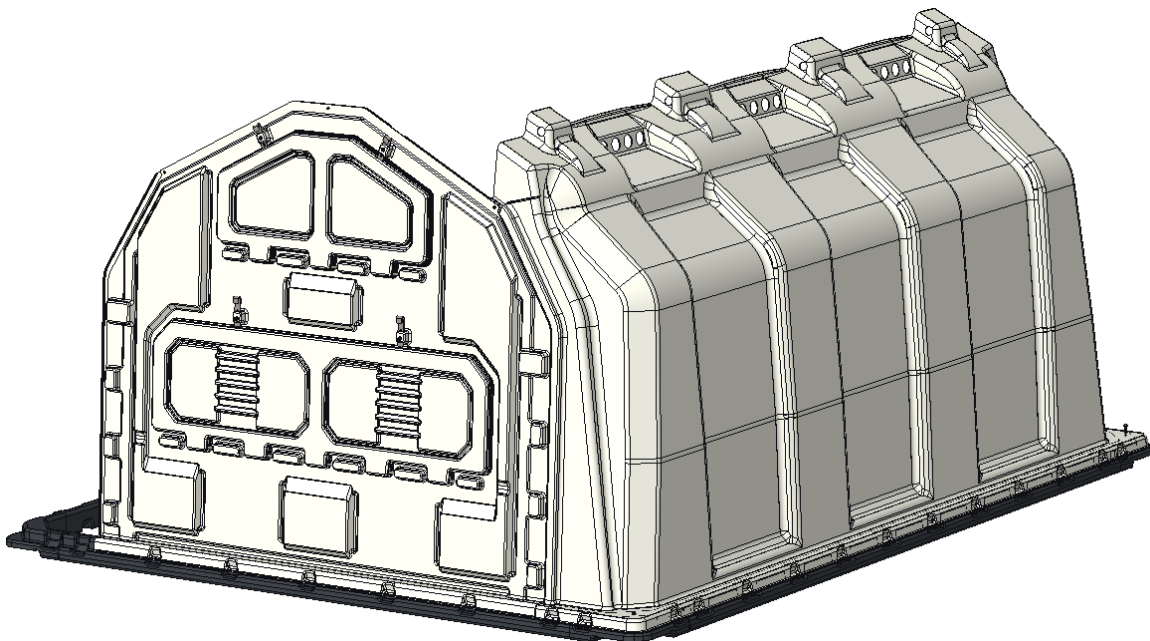



Step 5: Add Right Side Panel

- Same as Step 3, but first;
 - Slide CTG-1002 Right Side Panel into the CTG-1005 Back Panel, like Step 4
 - Then screw down the panel to the base.

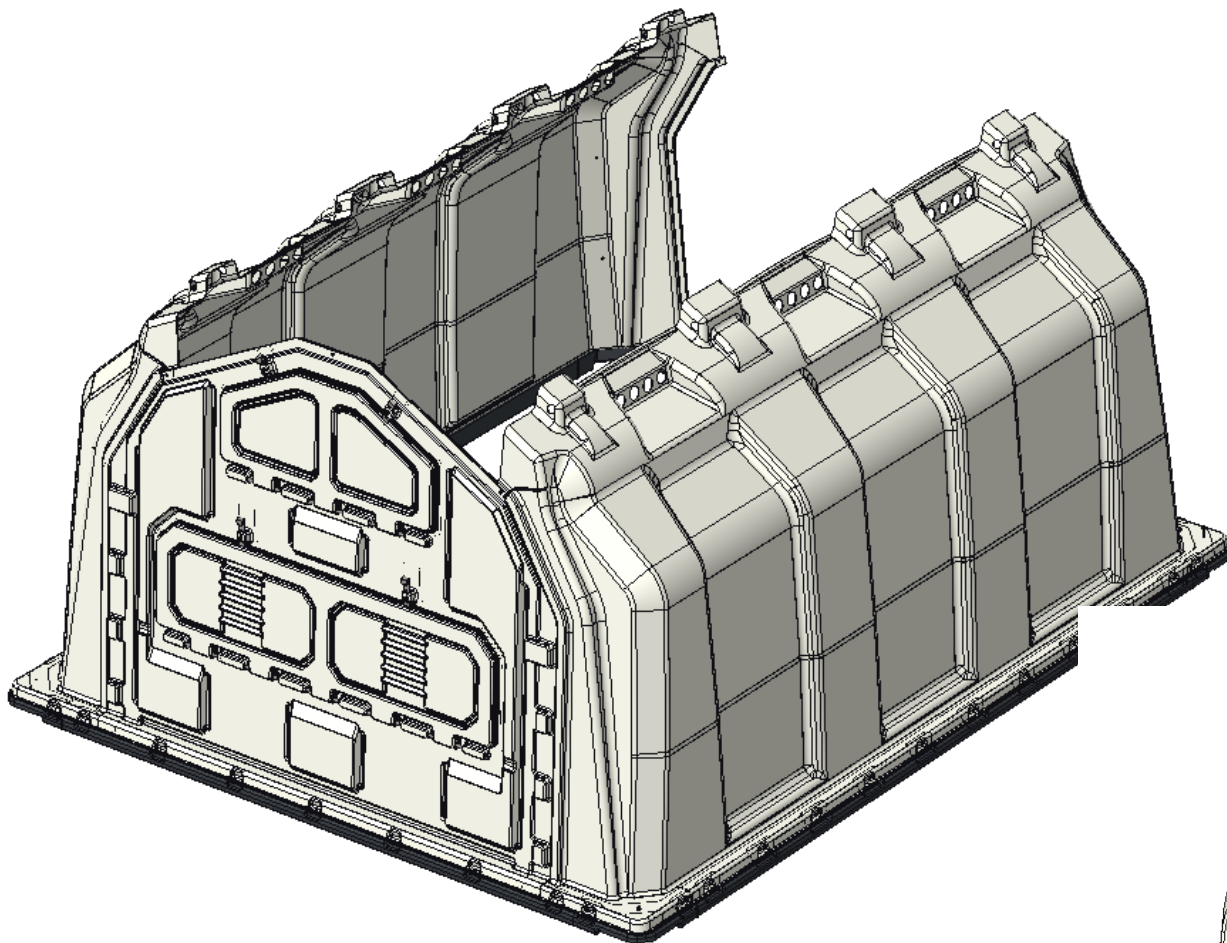

- Insert the included steel rod through the holes in CTG-1005 Back Panel and both CTG-1001 & CTG-1002 Side Panels to lock them together

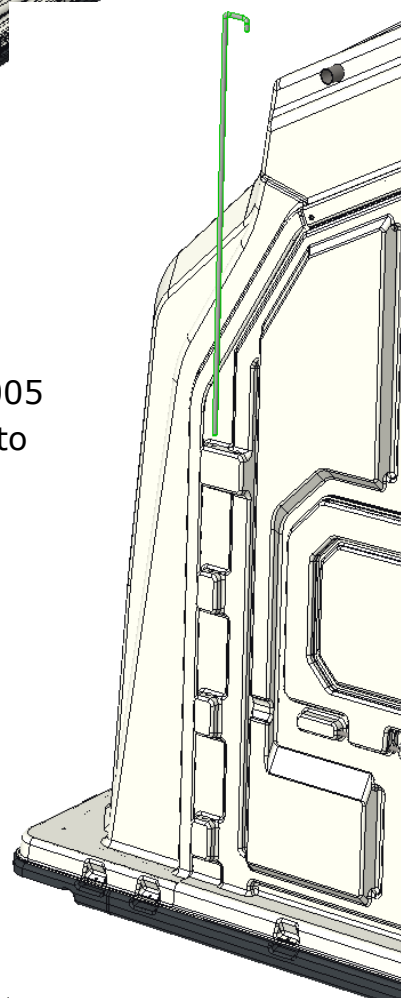



Step 6: Add the Roof

- Remove 2 Round pipes in CTG-1003 Roof
- Place CTG-1003 Roof on top of the Side Panels.

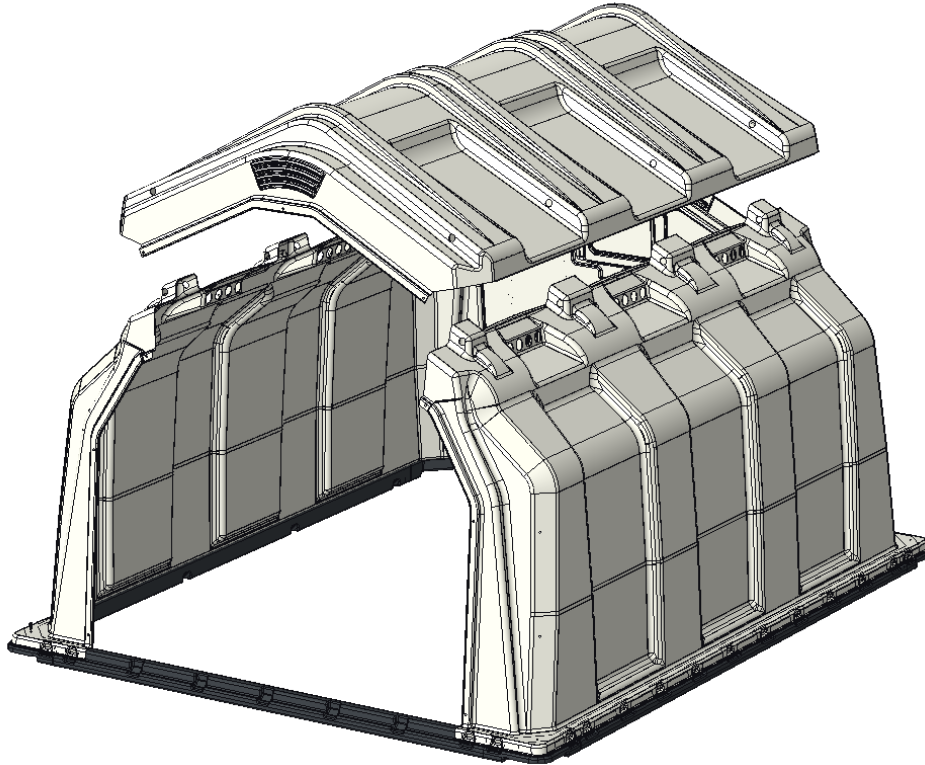

Step 7: Secure the Roof & Install Lifting Device

- To attach the roof, slide the Round Pipes (2 per) through the corresponding holes in the roof and Side Panels. A helper inside the unit helps align the holes.
- Stop sliding the pipes about halfway
- Position the CTG-1011 Lifting Device between the center two roof ribs
- Finish sliding the pipes through both the roof and lifting device bracket to secure

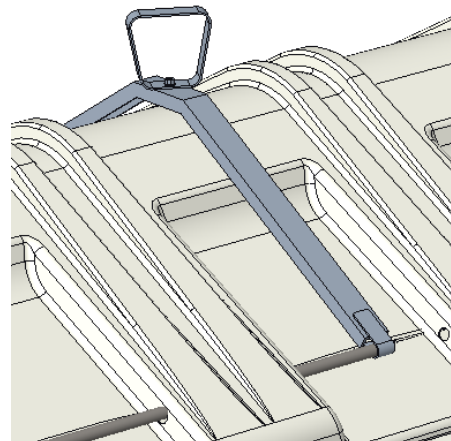
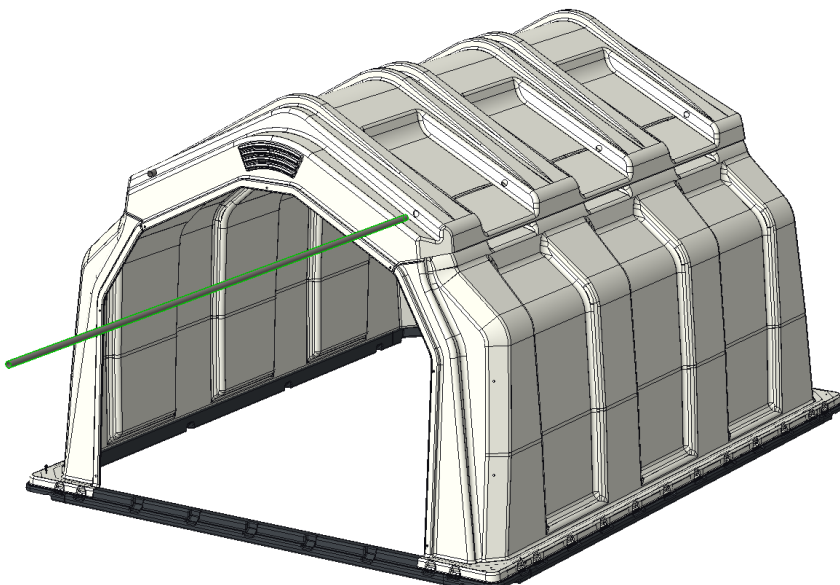



Step 8: Install the Steel Front Frame

- Align upper center hole in CTG-1004 Steel Front Frame with upper hole in roof
- Use 5/16" nut and bolt from hardware kit to fasten together

Make sure:

- Flat side faces outward
- Thick steel threshold sits over the plastic rail

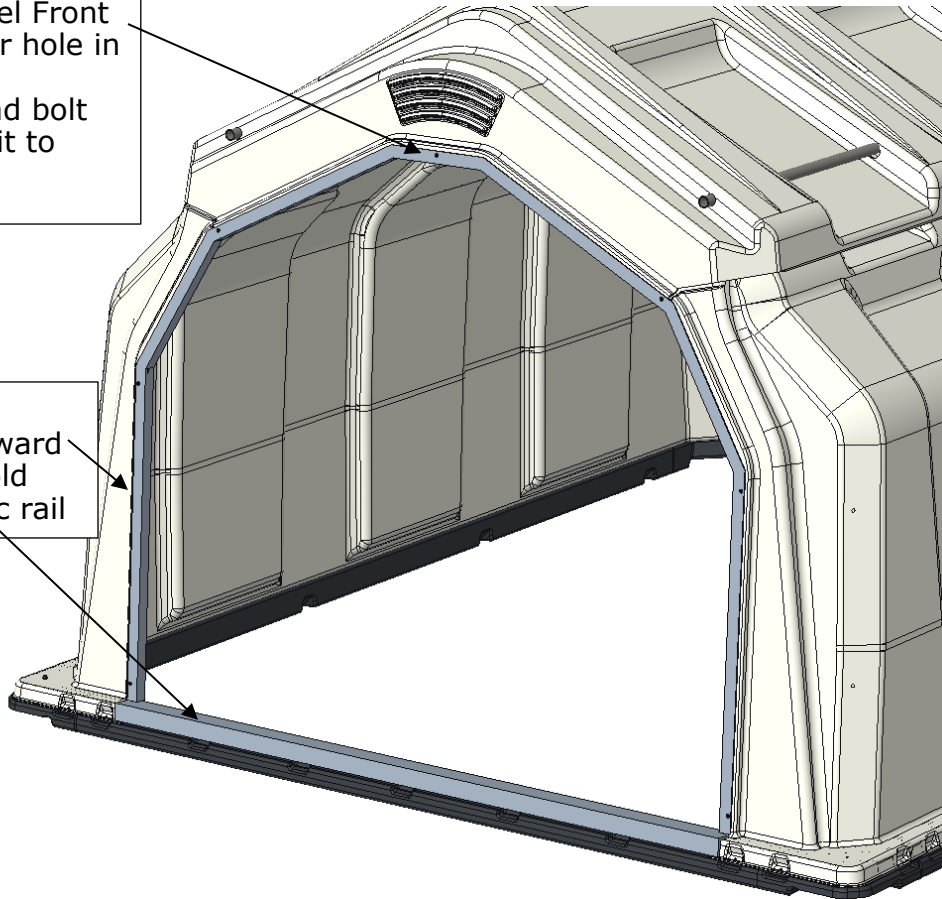

Step 9: Secure Steel Frame to Panels

- Use the 6 extra holes in the frame as guides
- Mark or drill through the panel
- Fasten using the 5/16" hardware provided

Fastening locations

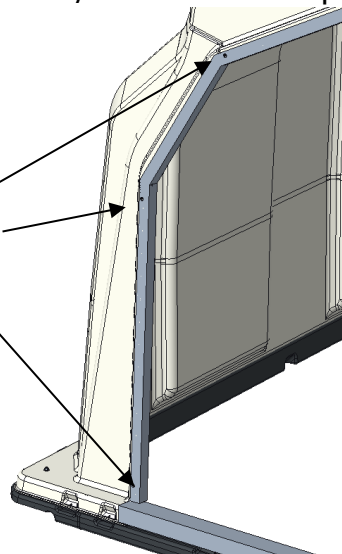

Fastening locations

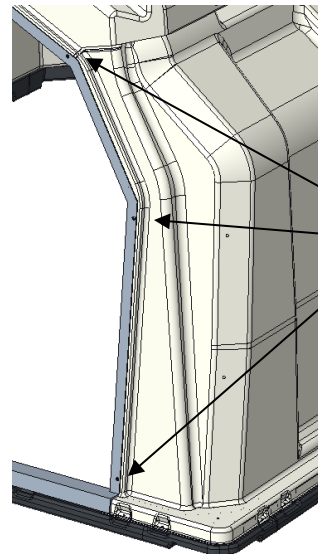



Step 10: Secure Back Panel to Roof

- Align upper center hole in the back panel with upper hole in roof
- use 5/16" nut and bolt from hardware kit to fasten together

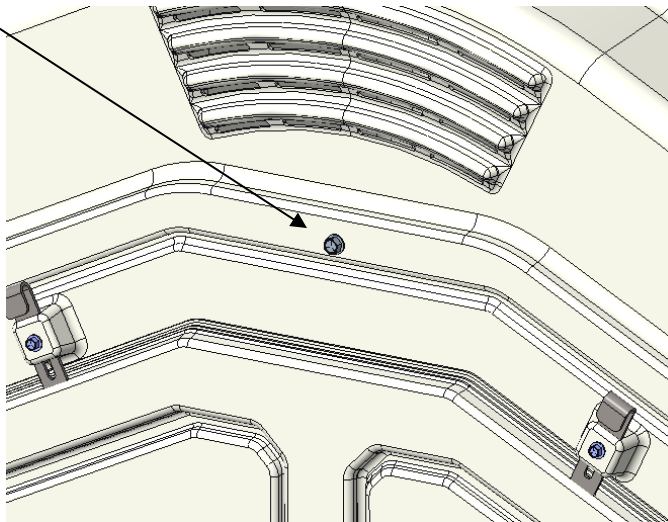

- Mark or drill through remaining roof holes into the back panel
- Use 5/16" nut and bolt from hardware kit to fasten together

Fastening locations

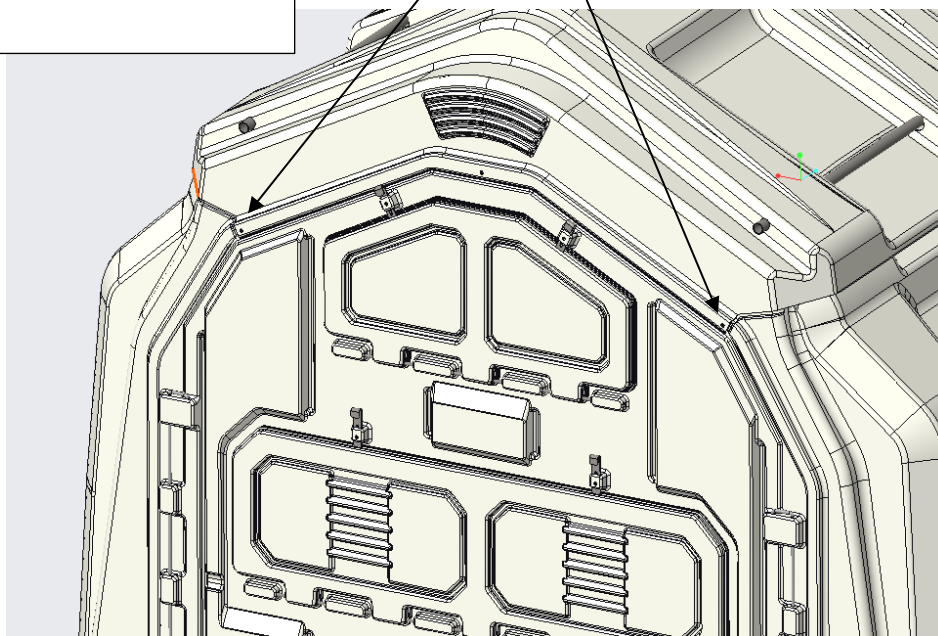



Step 11: Final Assembly – Secure to Base

- Use the 27 pre-drilled panel holes to attach all panels to the base rails
- Use self-drilling screws and washers
- Ensure your drill is perpendicular and apply firm pressure so the screw goes into both the plastic and steel pipe inside

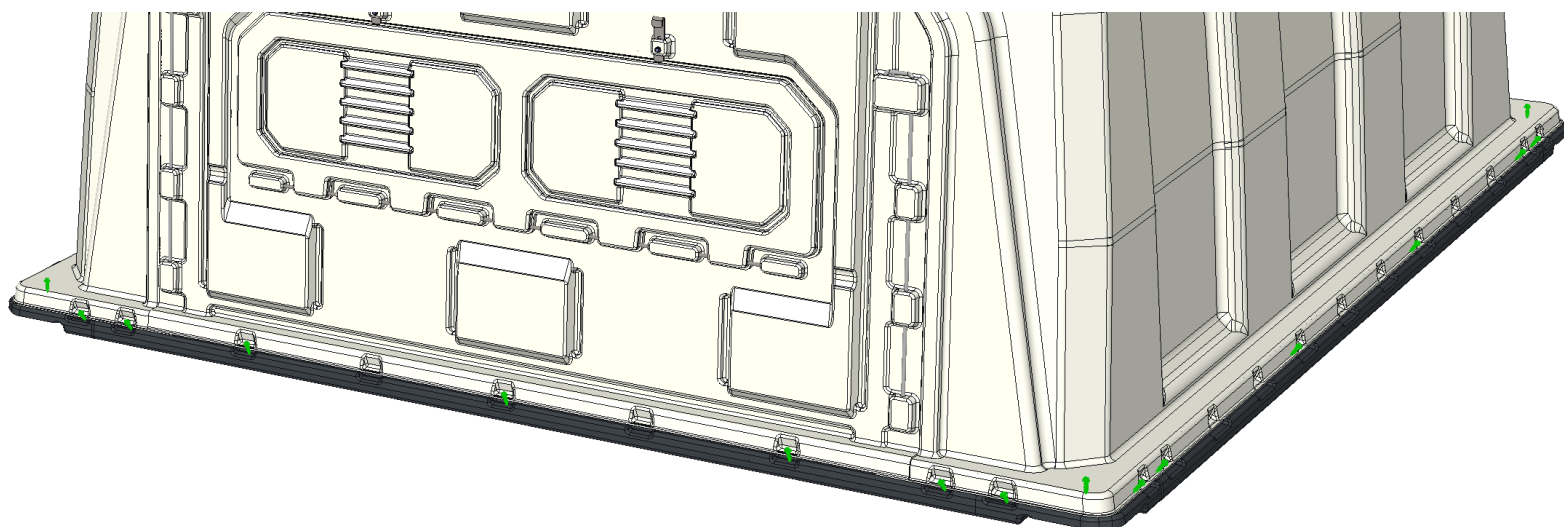
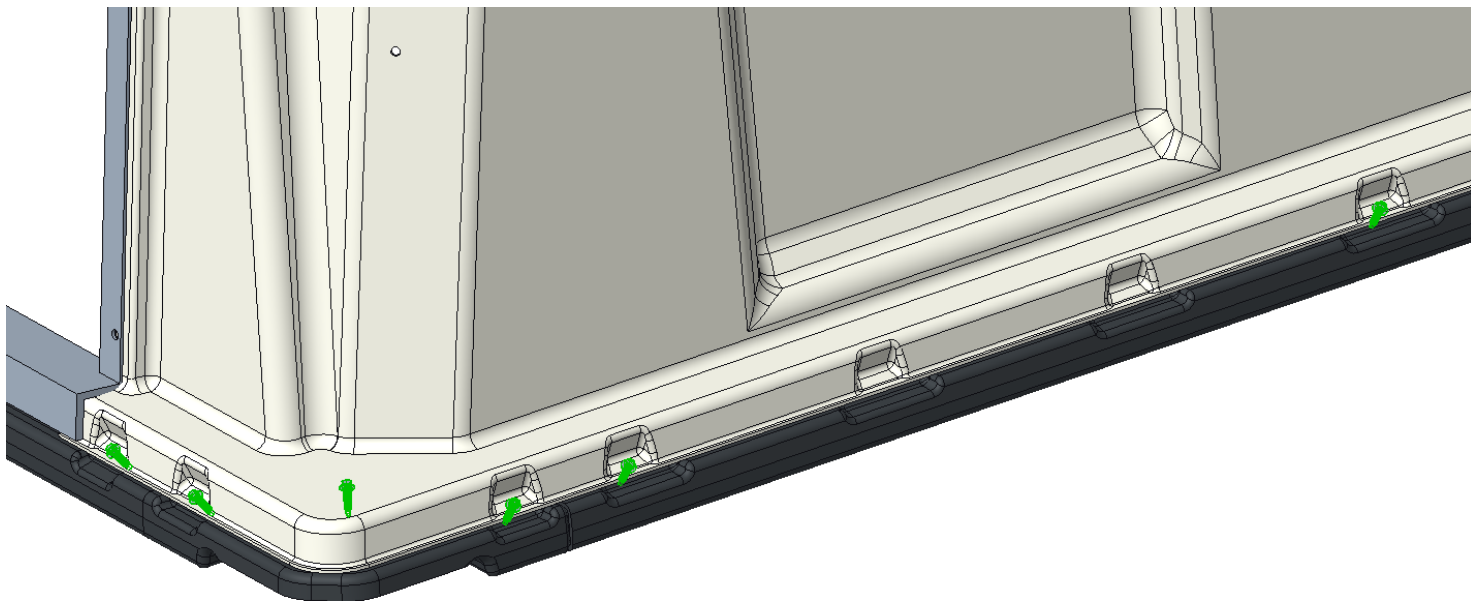

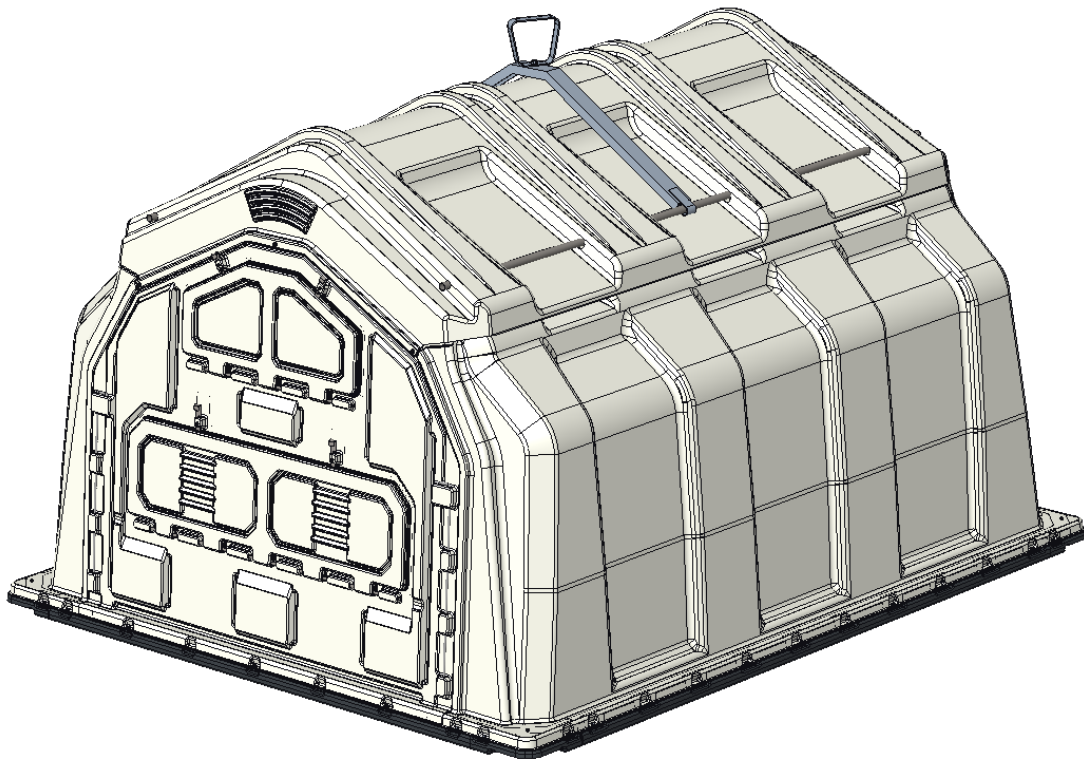
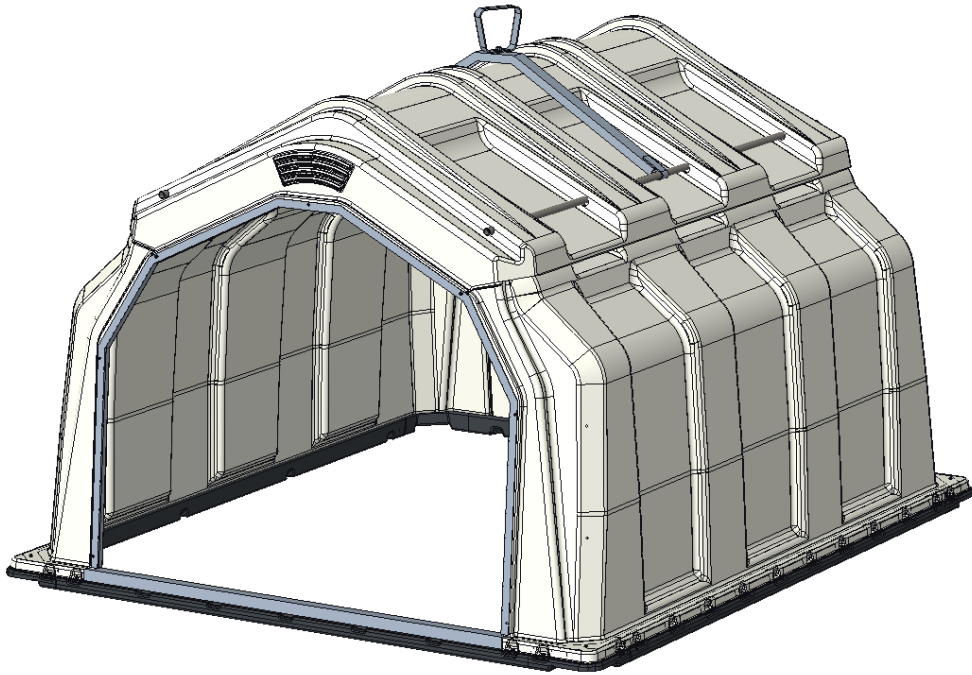

Safety Note

Mammoth should always be lifted using the supplied Lifting Device and should not be tipped up onto sides or ends.